

## General Parts & Replacenents

### Air Handpieces Replacement Parts



#### Air Handpieces Replacement Parts - MARATHON

Air Handpieces Replacement Parts - MARATHON

| Code   | Name                            | Price      | +                     |
|--------|---------------------------------|------------|-----------------------|
| 113925 | Air Handpiece Collet Chuck Only | US\$ 16.80 | <a href="#">+Info</a> |

## General Parts & Replacenents

### ART Replacement parts ( Bonart )



#### ART Replacement parts ( Bonart ) - BONART

ART Replacement parts ( Bonart ) - BONART

| Code   | Name                     | Price      | +                     |
|--------|--------------------------|------------|-----------------------|
| 451797 | ART DC35V Solenoid Valve | US\$ 92.40 | <a href="#">+Info</a> |

#### Scaler Parts - BONART

Scaler Parts - BONART



| Code   | Name                             | Price       | +                     |
|--------|----------------------------------|-------------|-----------------------|
| 421120 | ART-Pelican Scaler LED HP ONLY   | US\$ 177.80 | <a href="#">+Info</a> |
| 451801 | ART-MB3 110v Transformer         | US\$ 92.40  | <a href="#">+Info</a> |
| 464809 | ART-PB3 110v Blue control box    | US\$ 207.20 | <a href="#">+Info</a> |
| 469815 | REGULAR Piezo handpiece only     | US\$ 138.60 | <a href="#">+Info</a> |
| 469893 | Piezo Cable for P6 & P3II        | US\$ 77.00  | <a href="#">+Info</a> |
| 474338 | BONART - ART-PB3 110vol PC Board | US\$ 207.20 | <a href="#">+Info</a> |

## General Parts & Replacenents

### ASEPTICO Replacement Parts



#### ASEPTICO Replacement Parts - ASEPTICO

ASEPTICO Replacement Parts - ASEPTICO

| Code   | Name                                | Price          | +     |
|--------|-------------------------------------|----------------|-------|
| 464772 | CASE CARRYING with W/HANDLES ADC-01 | US\$ 274.40    | +Info |
| 464784 | DC CABLE WITH AUTOMOTIVE POWER PLUG | US\$ 165.41    | +Info |
| 464783 | DC CABLE WITH BATTERY CLIPS ALU-40L | US\$ 147.00    | +Info |
| 464782 | FUSE 5X20MM SLO-BLO .160A           | US\$ 6.01      | +Info |
| 464781 | UV FILTER ALU-40LED                 | US\$ 4.48      | +Info |
| 464780 | LENS COVER ALU-40LED                | US\$ 14.56     | +Info |
| 464779 | CASE CARRYING ALU-27/29 with W/BLU  | US\$ 156.80    | +Info |
| 464775 | LEG ADJUST PIN ASSY ( Assembly ) A  | US\$ 16.66     | +Info |
| 464774 | CASE ADC-09 STOOL CARRYING GRY WITH | US\$ 225.40    | +Info |
| 464785 | FILTER REPLACEMENT KIT ALU-40LED    | US\$ 20.16     | +Info |
| 464771 | CASE ADC-08 STOOL CARRYING GRY WITH | US\$ 176.40    | +Info |
| 464770 | BACK SUPPORT ASSY ( Assembly ) ADC  | US\$ 147.00    | +Info |
| 464769 | TRAY STAINLESS MAYO 19-1/8 X 12-5/8 | US\$ 186.20    | +Info |
| 464768 | TRAY STAINLESS RITTER 13-11/16 X 9- | US\$ 88.66     | +Info |
| 464767 | FIBER OPTIC 1 HP ILLUMINATION SYSTE | US\$ 676.20    | +Info |
| 464766 | FIBER OPTIC TUBING STRAIGHT GRAY 6- | US\$ 254.80    | +Info |
| 464765 | FIBER OPTIC 1 HP ILLUMINATION SYSTE | US\$ 676.20    | +Info |
| 464764 | WATER SYS SELF-CONT INSTALLED NON-S | US\$ 127.40    | +Info |
| 464787 | KIT CUSPID CHAIN / GRID             | US\$ 365.05    | +Info |
| 464788 | KIT BICUSPID CHAIN / GRID           | US\$ 365.05    | +Info |
| 464789 | KIT INCISOR CHAIN / GRID            | US\$ 365.05    | +Info |
| 464790 | LINGUAL BUTTONS PKG/6               | US\$ 40.87     | +Info |
| 464791 | MOTOR / CABLE ASSY ( Assembly ) M1  | US\$ 176.40    | +Info |
| 464793 | PORTA-TIP RECHARGEABLE SYSTEM BLK 1 | US\$ 716.80    | +Info |
| 464794 | ELECTROMICRO POWER-TIP GRY 220 **IN | US\$ 977.55    | +Info |
| 464795 | KIT LEG ADU-40CF BASE ASSY ( Assemb | US\$ 451.50    | +Info |
| 464796 | ASEPTICHAIR WITH CASE 6520-01-446-3 | US\$ 2,859.38  | +Info |
| 464797 | MILITARY PORTABLE CHAIR             | US\$ 6,890.63  | +Info |
| 464799 | COMMAND FIELD ADVANCED MIL OPERATOR | US\$ 3,375.00  | +Info |
| 464800 | COMMAND FIELD ADVANCED MIL OPERATOR | US\$ 1,260.00  | +Info |
| 464801 | TRANSPORT III COMMAND FIELD DUAL VO | US\$ 15,750.00 | +Info |
| 464802 | TRANSPORT III WITH HANDPIECES MILIT | US\$ 21,843.75 | +Info |
| 464803 | LIGHT PORTABLE LED OPERATORY 6520-0 | US\$ 1,873.13  | +Info |
| 464724 | MOTOR/CABLE ASSY ( Assembly ) AE-2  | US\$ 1,349.95  | +Info |
| 464733 | FUSE 5X20 TIME DELAY 3.0 AMP        | US\$ 7.99      | +Info |
| 464732 | FUSE 5X20MM SLO-BLO 0.630A          | US\$ 7.99      | +Info |
| 464730 | FUSE 5X20MM SLO-BLO 6.3A 250V       | US\$ 4.00      | +Info |
| 464729 | BOTTLE 750ml (25oz) BLOW MOLDED HDP | US\$ 15.68     | +Info |
| 464728 | WASTE TANK ASSY ( Assembly ) AEU-5  | US\$ 646.80    | +Info |
| 464727 | KIT HIGH VAC WASTE CONTAINER AEU-42 | US\$ 420.42    | +Info |
| 464726 | KIT SALIVA WASTE CONTAINER AEU-425  | US\$ 450.45    | +Info |
| 464725 | MOTOR/CABLE ASSY ( Assembly ) AE-2  | US\$ 1,451.45  | +Info |
| 464734 | FUSE 5X20MM MEDIUM TIME DELAY 6.3A  | US\$ 4.00      | +Info |
| 464723 | BRACKET ASSY ( Assembly ) UNDER CO  | US\$ 68.60     | +Info |
| 464720 | HANDPIECE KAVO 6-PIN LED FIBER OPTI | US\$ 362.60    | +Info |
| 464711 | ADAPTER AHP-09 with W/ O-RING       | US\$ 13.44     | +Info |
| 464709 | IRRIGATION TUBE/CLIP FOR 4330D      | US\$ 47.04     | +Info |
| 464702 | DEPTH STOP ONLY FOR AHP-85MB-C      | US\$ 126.49    | +Info |

|        |                                     |               |       |
|--------|-------------------------------------|---------------|-------|
| 464698 | CLIP MONT BLANC EXTERNAL            | US\$ 46.94    | +Info |
| 464697 | CANNULA MONT BLANC INTERNAL         | US\$ 29.40    | +Info |
| 464695 | TUBE EXTERNAL IRRIGATION 6.5" L .04 | US\$ 12.60    | +Info |
| 464735 | FUSE 6A 250V 1/4 X 1-1/4 TIME DELAY | US\$ 4.00     | +Info |
| 464736 | FUSE 3.0A 250V 1/4 X 1-1/4 TIME DEL | US\$ 7.99     | +Info |
| 464738 | FILTER AA-20BF-2 BACTERIA           | US\$ 13.44    | +Info |
| 464739 | CANISTER 800ml REPLACEMENT FOR AA-2 | US\$ 33.32    | +Info |
| 464740 | VACUUM SALIVA EJECTOR CART KIT      | US\$ 686.00   | +Info |
| 464741 | KIT UNIVERSAL CENTRAL VAC CART REF  | US\$ 245.00   | +Info |
| 464742 | VACUUM SCREEN FOR AA-290 1-7/8 TRAP | US\$ 4.00     | +Info |
| 464747 | ERGO TIP CASSETTE ADAPTER HUB SCALE | US\$ 32.34    | +Info |
| 464753 | FIBER OPTIC 6 PIN with W/120V TRANS | US\$ 1,271.27 | +Info |
| 464754 | FIBER OPTIC 5 HOLE LED with W/120V  | US\$ 1,321.32 | +Info |
| 464755 | AUXILIARY ARM MOBILE DENTAL CART SY | US\$ 525.00   | +Info |
| 464756 | AMALGAM SEPARATOR AMC-25 CART KIT   | US\$ 791.35   | +Info |
| 464758 | HOSPITAL AIR/VACUUM BYPASS KIT AMC- | US\$ 1,671.67 | +Info |
| 464760 | ENDO-CART BASE MODEL                | US\$ 2,397.50 | +Info |
| 464763 | FOLDING ARM WALL MTG ASSY ( Assembl | US\$ 450.45   | +Info |

### General Parts & Replacenents

## BestQual Replacement parts



### Parts for LC Curing Units BesQual



| Code   | Name  | Price      | +     |
|--------|---|------------|-------|
| 124496 | BESQUAL E300N Replacement Bulb for Curing Light Unit -#920-101 - Best-Qual Maxi-... | US\$ 13.60 | +Info |

### General Parts & Replacenents

## BUFFALO Replacement parts



### BUFFALO Replacement parts - MARATHON

BUFFALO Replacement parts - MARATHON

| Code | Name | Price | + |
|------|------|-------|---|
|------|------|-------|---|

|        |                                |             |                       |
|--------|--------------------------------|-------------|-----------------------|
| 116167 | MARATHON Champion 40K RPM 220v | US\$ 210.49 | <a href="#">+Info</a> |
|--------|--------------------------------|-------------|-----------------------|

## Buffalo Micromotor Replacement Parts - BUFFAL

O



See description - Replacement Console ONLY

### Other Models

Other Models

| Code   | Name                                | Price       | +                     |
|--------|-------------------------------------|-------------|-----------------------|
| 424517 | X35 Micromotor Lab Foot Pedal       | US\$ 88.04  | <a href="#">+Info</a> |
| 424584 | V35 Electric Foot Control Only      | US\$ 81.54  | <a href="#">+Info</a> |
| 424756 | Bantam Engine HP Arm                | US\$ 211.20 | <a href="#">+Info</a> |
| 424837 | V35 Electric Lab Handpiece System S | US\$ 13.44  | <a href="#">+Info</a> |
| 424855 | X35 Handpiece Coiled Cord only      | US\$ 20.44  | <a href="#">+Info</a> |
| 425053 | V35 Electric Lab Handpiece System C | US\$ 272.64 | <a href="#">+Info</a> |
| 425054 | X50 Electric Lab Foot Control Only  | US\$ 163.15 | <a href="#">+Info</a> |
| 425060 | X50 Electric Lab Console Only       | US\$ 567.60 | <a href="#">+Info</a> |
| 425061 | X50 Electric Lab Handpiece Console  | US\$ 582.12 | <a href="#">+Info</a> |
| 425068 | V35 Console (Control Box) Only      | US\$ 312.32 | <a href="#">+Info</a> |
| 425069 | 3/32" HP Chuck for 2                | US\$ 26.60  | <a href="#">+Info</a> |
| 425078 | X35 Micromotor Lab Handpiece Multi- | US\$ 10.79  | <a href="#">+Info</a> |
| 425080 | Magic Wand Foot Control Only Consol | US\$ 83.99  | <a href="#">+Info</a> |
| 425421 | 3/32" HP Chuck for X50              | US\$ 26.07  | <a href="#">+Info</a> |

### X35

X35

| Code   | Name                           | Price      | +                     |
|--------|--------------------------------|------------|-----------------------|
| 475018 | X35 Micromotor Lab Fuse Holder | US\$ 23.40 | <a href="#">+Info</a> |

### OPTI WorkStation replacement parts



| Code   | Name  | Price      | +                     |
|--------|---|------------|-----------------------|
| 424673 | BUFFALO Opti Workstation Replacement Front Window For Opti Workstation. Window o... | US\$ 36.19 | <a href="#">+Info</a> |
| 425087 | BUFFALO Opti Workstation, Replacement Light Bulb 110V AC. Light bulb only - #67055B | US\$ 13.68 | <a href="#">+Info</a> |

### General Parts & Replacenents

## Dentsply Replacement Parts

### Dentsply Replacement Parts - DENTSPLY

Dentsply Replacement Parts - DENTSPLY

| Code   | Name                           | Price       | +                     |
|--------|--------------------------------|-------------|-----------------------|
| 417733 | Quick Cool Spacer              | US\$ 4.00   | <a href="#">+Info</a> |
| 417734 | Serv;Firing Platform- Qck Cool | US\$ 136.16 | <a href="#">+Info</a> |
| 417736 | Serv; Mpa2000 Pc-Screws        | US\$ 44.64  | <a href="#">+Info</a> |
| 417737 | Serv;Mpa2000 Pc-Lamp- Cntrl Bd | US\$ 336.16 | <a href="#">+Info</a> |
| 417738 | Serv;Mpa2000 Pc-Blck Metal Cvr | US\$ 44.64  | <a href="#">+Info</a> |
| 417739 | Serv;Mpa2000 Pc-Bubble Envelop | US\$ 44.64  | <a href="#">+Info</a> |
| 417740 | Service Charge                 | US\$ 420.48 | <a href="#">+Info</a> |
| 417741 | P2000 Fitting                  | US\$ 4.75   | <a href="#">+Info</a> |
| 417742 | Crown Holder                   | US\$ 155.36 | <a href="#">+Info</a> |
| 417743 | Porcelain Tray/Rack            | US\$ 22.88  | <a href="#">+Info</a> |
| 417744 | Muffle Heater Coil             | US\$ 641.28 | <a href="#">+Info</a> |
| 417745 | Taper Sagger Tray Pins         | US\$ 58.56  | <a href="#">+Info</a> |
| 417746 | Assy; Selector Valve           | US\$ 140.80 | <a href="#">+Info</a> |
| 417747 | Hose Fitting- .170 Id-#S445-1  | US\$ 4.80   | <a href="#">+Info</a> |

|        |                               |             |       |
|--------|-------------------------------|-------------|-------|
| 417748 | Fitting- Air Tube             | US\$ 16.48  | +Info |
| 417749 | Cap O-Ring 2-016 N674-70      | US\$ 4.00   | +Info |
| 417750 | Adjusting Screw               | US\$ 22.56  | +Info |
| 417751 | Upper Bearing Holder          | US\$ 14.88  | +Info |
| 417752 | Plate; Upper End              | US\$ 37.28  | +Info |
| 417753 | Rotor Housing                 | US\$ 297.28 | +Info |
| 417754 | Motor Vane                    | US\$ 10.44  | +Info |
| 417755 | Shuttle Pin                   | US\$ 4.48   | +Info |
| 417757 | Motor Seal                    | US\$ 13.92  | +Info |
| 417758 | Lower Bearing Holder          | US\$ 67.68  | +Info |
| 417759 | Motor Base O-Ring #2-015      | US\$ 4.00   | +Info |
| 417760 | Hose Pvc- .17 Id X .25 Od     | US\$ 9.00   | +Info |
| 417761 | Washer; Felt                  | US\$ 4.00   | +Info |
| 417762 | Front Bearing Protector       | US\$ 15.20  | +Info |
| 417763 | Spring Washer                 | US\$ 4.00   | +Info |
| 417764 | Box; 6 X 6 X 6                | US\$ 4.00   | +Info |
| 417765 | Motor Cap W/O-Ring            | US\$ 37.28  | +Info |
| 417766 | Valve; Foot Control           | US\$ 23.36  | +Info |
| 417767 | Foot Control Muffler 2P       | US\$ 22.56  | +Info |
| 417768 | Valve Spring- .181 X 1.062    | US\$ 4.00   | +Info |
| 417769 | Muffler Cap                   | US\$ 4.00   | +Info |
| 417770 | Hose Set O-Ring 2-115-N674-70 | US\$ 4.00   | +Info |
| 417771 | Valve Block AssY              | US\$ 350.40 | +Info |
| 417772 | Valve Assy                    | US\$ 21.92  | +Info |
| 417773 | Hose Set T200                 | US\$ 41.12  | +Info |
| 417774 | Cable Tie Package             | US\$ 4.75   | +Info |
| 417775 | Bump-On-Feet- Sj-5012 Gray    | US\$ 4.00   | +Info |
| 417776 | Push Rod Guide; Lower         | US\$ 21.12  | +Info |
| 417777 | Turbine Housing               | US\$ 97.28  | +Info |
| 417778 | Hurricane Handle Assembly     | US\$ 329.12 | +Info |
| 417779 | Motor Bearing Sr 3-3          | US\$ 24.16  | +Info |
| 417780 | Spindle Bearing Sr 4-3        | US\$ 38.08  | +Info |
| 417781 | Spindle- Gh                   | US\$ 103.20 | +Info |
| 417782 | Upper Push Rod                | US\$ 103.20 | +Info |
| 417783 | Housing- Spindle Gh           | US\$ 87.36  | +Info |
| 417784 | Turbine; Old Style- Gh        | US\$ 39.04  | +Info |
| 417785 | Handle; Stainless Steel       | US\$ 83.36  | +Info |
| 417786 | Upper Push Rod Guide          | US\$ 14.88  | +Info |
| 417788 | Valve Housing AssY Intake     | US\$ 122.24 | +Info |
| 417789 | Assy- Valve Housing Exhaust   | US\$ 109.28 | +Info |
| 417790 | Spindle Housing- Clear        | US\$ 37.12  | +Info |
| 417791 | Bearing Spacer                | US\$ 15.68  | +Info |
| 417792 | Bearing; Protector            | US\$ 10.12  | +Info |
| 417794 | Push Rod Spring               | US\$ 4.00   | +Info |
| 417795 | Air Tube; Intake              | US\$ 23.52  | +Info |
| 417796 | Knob; Push Rod                | US\$ 27.36  | +Info |
| 417797 | Push Rod                      | US\$ 34.88  | +Info |
| 417798 | Bearing- High Speed           | US\$ 47.04  | +Info |
| 417799 | O-Ring 2122- 5-204            | US\$ 4.00   | +Info |



|        |                               |             |       |
|--------|-------------------------------|-------------|-------|
| 417800 | Chuck Tool                    | US\$ 20.32  | +Info |
| 417801 | Spindle Assy; Retainer        | US\$ 28.64  | +Info |
| 417802 | Washer; Spring                | US\$ 4.00   | +Info |
| 417803 | Spindle Complete              | US\$ 103.20 | +Info |
| 417804 | Turbine; Turbo 300            | US\$ 67.68  | +Info |
| 417805 | Mandrel                       | US\$ 35.04  | +Info |
| 417806 | Tool Ejector Assy             | US\$ 67.84  | +Info |
| 417807 | Muffler Pak                   | US\$ 9.68   | +Info |
| 417808 | 6 Pak- Muffler                | US\$ 22.40  | +Info |
| 417809 | Chuck Tool Package            | US\$ 20.96  | +Info |
| 417810 | Cam Follower                  | US\$ 29.12  | +Info |
| 417811 | Spring 55#                    | US\$ 19.04  | +Info |
| 417812 | Chuck Follower- Qc            | US\$ 43.39  | +Info |
| 417813 | Washer; Spring Wo 618-008-S   | US\$ 4.00   | +Info |
| 417814 | Lever                         | US\$ 30.88  | +Info |
| 417815 | Cam; Heat Treat               | US\$ 39.84  | +Info |
| 417817 | Chuck 1/8                     | US\$ 180.48 | +Info |
| 417818 | Bearing Retainer              | US\$ 20.48  | +Info |
| 417819 | Ball Check                    | US\$ 26.56  | +Info |
| 417820 | Lever Spring                  | US\$ 4.00   | +Info |
| 417821 | Spindle Tool                  | US\$ 43.36  | +Info |
| 417822 | Cam Washer                    | US\$ 4.00   | +Info |
| 417823 | Qc Motor Assy                 | US\$ 881.12 | +Info |
| 417824 | Qc 600 Handle Assy            | US\$ 797.28 | +Info |
| 417825 | Lever Assy                    | US\$ 66.72  | +Info |
| 417826 | Qce Spring Retainer Assy      | US\$ 46.88  | +Info |
| 417827 | O-Ring 2-003                  | US\$ 4.00   | +Info |
| 417828 | Lever Screw 2-56 X 1/8        | US\$ 4.00   | +Info |
| 417829 | Roll Pin; 1/16 X 7/16         | US\$ 4.00   | +Info |
| 417830 | Lever Casting                 | US\$ 14.56  | +Info |
| 417831 | Tip Assembly- Shielded        | US\$ 69.12  | +Info |
| 417832 | Spindle Cap- Slotted          | US\$ 46.24  | +Info |
| 417833 | Rotor; Air Drive              | US\$ 169.76 | +Info |
| 417834 | Drive- Air Coupling           | US\$ 52.80  | +Info |
| 417835 | Tip Insert- Shielded          | US\$ 11.84  | +Info |
| 417836 | Keeper; Lht- Complete         | US\$ 33.76  | +Info |
| 417837 | Handle Blank Lht              | US\$ 110.56 | +Info |
| 417838 | Spindle; Qce                  | US\$ 201.92 | +Info |
| 417839 | Low Speed Hp Repair           | US\$ 477.28 | +Info |
| 417840 | High Speed Hp Repair          | US\$ 308.80 | +Info |
| 417841 | Turbine Assy Repair           | US\$ 266.08 | +Info |
| 417842 | Retainer; C Clip Irr #2000-12 | US\$ 4.00   | +Info |
| 417843 | Sleeve- Cover Gh              | US\$ 33.28  | +Info |
| 417844 | Lock Nut; Spindle Gh          | US\$ 42.88  | +Info |
| 417845 | Bearing Protector- Gh         | US\$ 20.32  | +Info |
| 417846 | O-Ring- Seal Gh               | US\$ 10.57  | +Info |
| 417848 | Air Tube- Gh                  | US\$ 14.24  | +Info |
| 417849 | Push Rod Stem- Gh             | US\$ 14.72  | +Info |
| 417850 | Push Rod Knob                 | US\$ 21.44  | +Info |

|        |                                |             |       |
|--------|--------------------------------|-------------|-------|
| 417852 | Grand Hurricane Handle Assy    | US\$ 424.64 | +Info |
| 417853 | Nose Cap Spindle New Style     | US\$ 35.52  | +Info |
| 417854 | Push Rod Assy- Gh Service      | US\$ 244.96 | +Info |
| 417855 | Hose Fitting- 1/8-27Npt X.17ld | US\$ 9.00   | +Info |
| 417856 | Motor Base Lock Ring           | US\$ 24.96  | +Info |
| 417857 | Serv; Revolution Hp- Chuck     | US\$ 116.00 | +Info |
| 417858 | Serv;Revolution- Carbon Brush  | US\$ 56.64  | +Info |
| 417859 | Turbine Housing Assy- Gh       | US\$ 143.52 | +Info |
| 417860 | Burr; Insertion Tool           | US\$ 35.52  | +Info |
| 417861 | Chuck Tool Package- Gh         | US\$ 61.60  | +Info |
| 417862 | Screw; Mufflr- Metal 1/4-28    | US\$ 11.36  | +Info |
| 417863 | Motor Housing Assy             | US\$ 174.08 | +Info |
| 417864 | Motor Cap; Black               | US\$ 43.39  | +Info |
| 417865 | Qc Base- Anodized Black        | US\$ 66.88  | +Info |
| 417866 | Motor Lock Ring-Black          | US\$ 25.44  | +Info |
| 417867 | Tip; Qc700                     | US\$ 51.20  | +Info |
| 417873 | Lock Ring; Spindle Retainer    | US\$ 26.88  | +Info |
| 417874 | Lock Ring; Tool Ejector        | US\$ 60.00  | +Info |
| 417875 | Lock Ring- Gh                  | US\$ 32.16  | +Info |
| 417876 | Lock Ring- Upper Push Rod Guid | US\$ 43.39  | +Info |
| 417877 | Motor; Housing Assy- Black     | US\$ 414.08 | +Info |
| 417878 | Motor Housing; Air Tube- Black | US\$ 32.48  | +Info |
| 417879 | Oring Kit; Low Speed Foot Pedl | US\$ 12.32  | +Info |
| 417880 | Tubing 1/4                     | US\$ 9.90   | +Info |
| 417882 | Wire- 20Ga Type R              | US\$ 12.48  | +Info |
| 417883 | Resistor; 47 Ohm .250W Cf      | US\$ 4.00   | +Info |
| 417884 | Resistor; 100 Ohm .250W Cf     | US\$ 4.00   | +Info |
| 417885 | Resistor; 1K Ohm .250W Cf      | US\$ 4.00   | +Info |
| 417886 | Res. Network- 100K Sip5        | US\$ 4.00   | +Info |
| 417887 | Ic; Opto Coupler- Triac        | US\$ 4.75   | +Info |
| 417888 | Ic; Regulator +5V              | US\$ 4.00   | +Info |
| 417889 | Ic- Quad Nand                  | US\$ 4.00   | +Info |
| 417890 | Opto Isolator 4N35             | US\$ 3.68   | +Info |
| 417891 | Ic; Multiplexer Mc14051B       | US\$ 4.00   | +Info |
| 417892 | Ic; Lifier- Amplifier          | US\$ 15.52  | +Info |
| 417893 | Ic; Dual Amp Tlc27M2           | US\$ 8.55   | +Info |
| 417894 | Ic; Microprocessor C9          | US\$ 75.84  | +Info |
| 417895 | Ic; Zero Voltage Control       | US\$ 4.75   | +Info |
| 417896 | Ic; Latched Driver             | US\$ 9.54   | +Info |
| 417897 | Ic; Eeprom                     | US\$ 10.35  | +Info |
| 417898 | Ic; Micro Peripheral           | US\$ 41.76  | +Info |
| 417899 | Ic; Dc To Ac- Qex              | US\$ 35.36  | +Info |
| 417900 | Ic; Stepper Motor Dvrer-Epu li | US\$ 16.64  | +Info |
| 417901 | Power Fet; P Channel           | US\$ 11.84  | +Info |
| 417902 | Power Fet; N Channel           | US\$ 11.34  | +Info |
| 417903 | Triac; 8A- 400V                | US\$ 40.32  | +Info |
| 417904 | Cap- 100Uf 10V Alum            | US\$ 4.00   | +Info |
| 417905 | Cap. .1Uf 250V                 | US\$ 3.36   | +Info |
| 417906 | Capacitor; .01 50V Ceramic     | US\$ 4.00   | +Info |



|        |                                |             |       |
|--------|--------------------------------|-------------|-------|
| 417907 | Capacitor; 3.3Nf 1600Vdc       | US\$ 4.00   | +Info |
| 417908 | Serv; Capacitor                | US\$ 12.48  | +Info |
| 417909 | Diode 1N914/1N4148 75V Signal  | US\$ 4.00   | +Info |
| 417910 | Diode; 1N5346/47 9.1V Zener    | US\$ 4.00   | +Info |
| 417911 | Diode; Bridge 4A               | US\$ 4.00   | +Info |
| 417912 | Diode; 6A6                     | US\$ 4.75   | +Info |
| 417913 | Switch- Dpdt 16A               | US\$ 29.12  | +Info |
| 417914 | Switch; Dpst Lighted (Green)   | US\$ 13.44  | +Info |
| 417915 | Switch; Heater Thermal Cut-Off | US\$ 17.28  | +Info |
| 417916 | Switch; Dpst Power             | US\$ 6.97   | +Info |
| 417917 | Switch; Magnetic               | US\$ 16.64  | +Info |
| 417918 | Magnet; Door Switch            | US\$ 31.52  | +Info |
| 417919 | Magnet; Door Interlock         | US\$ 32.64  | +Info |
| 417920 | Switch- Resettable- 15A        | US\$ 18.08  | +Info |
| 417921 | Switch Thermal Cut-Off         | US\$ 32.48  | +Info |
| 417922 | Lamp- Neon                     | US\$ 4.00   | +Info |
| 417923 | Sensor; Receiver- Epu li       | US\$ 230.24 | +Info |
| 417924 | Sensor; Emitter- Epu li        | US\$ 195.68 | +Info |
| 417925 | Filter; Lamp- Epu li           | US\$ 164.32 | +Info |
| 417926 | Potentiometer- 1 Meg 1/4 Shaft | US\$ 11.16  | +Info |
| 417927 | Potentiometer- 2K              | US\$ 10.08  | +Info |
| 417928 | Receptacle; Pump- Snap-In- 120 | US\$ 14.08  | +Info |
| 417929 | Receptacle; Pump- Assy         | US\$ 14.08  | +Info |
| 417930 | Connector- .100- 3 Cir         | US\$ 4.00   | +Info |
| 417931 | Header 2 Pin .156              | US\$ 4.00   | +Info |
| 417932 | Fuse Connector                 | US\$ 10.26  | +Info |
| 417933 | Power Cord; 240V- 130/550      | US\$ 13.28  | +Info |
| 417934 | Plug- Accy Cord                | US\$ 9.90   | +Info |
| 417935 | Power Cord- 250V/20A 1750 Euro | US\$ 45.60  | +Info |
| 417936 | Cord- 125V/15A 12/3            | US\$ 43.39  | +Info |
| 417937 | Terminal- Pcb Type             | US\$ 3.52   | +Info |
| 417938 | Fuse Connector                 | US\$ 21.76  | +Info |
| 417939 | Cord; Power-120V               | US\$ 21.28  | +Info |
| 417940 | Fuse; Drawer                   | US\$ 10.80  | +Info |
| 417941 | Transformer 20 Vct Sa          | US\$ 45.60  | +Info |
| 417942 | Transformer- Pcb Type          | US\$ 28.48  | +Info |
| 417943 | Transformer- Current           | US\$ 15.68  | +Info |
| 417944 | Inductor; Choke 10A            | US\$ 112.64 | +Info |
| 417945 | Transformer; 1200Va            | US\$ 467.36 | +Info |
| 417946 | Pcb; Computer- Cure/Heat       | US\$ 73.60  | +Info |
| 417947 | Battery; Lithium 3V            | US\$ 8.10   | +Info |
| 417948 | Sonar Alert                    | US\$ 10.57  | +Info |
| 417949 | Ceramic Disc; Pzt4             | US\$ 29.12  | +Info |
| 417950 | Fuse 3 Amp Special             | US\$ 4.00   | +Info |
| 417951 | Fuse- 0.5 Amp 250V             | US\$ 4.00   | +Info |
| 417952 | Inrush Current Limiter         | US\$ 10.80  | +Info |
| 417953 | Fuse; 15 Amp                   | US\$ 4.00   | +Info |
| 417954 | Fuse- 10A 250V- Pwr Cord Sckt  | US\$ 4.00   | +Info |
| 417955 | Motor- Power Door- 12Vdc       | US\$ 327.52 | +Info |

|        |                                |             |       |
|--------|--------------------------------|-------------|-------|
| 417956 | Fuse; 3.15 Amp 5 X 20Mm        | US\$ 4.00   | +Info |
| 417957 | Relay- 10A Dpst                | US\$ 68.00  | +Info |
| 417958 | Fan Axial- Air Exch            | US\$ 194.72 | +Info |
| 417959 | Pcb; Power Supply- 25W         | US\$ 71.36  | +Info |
| 417960 | Fuse; 2.5A- 5X20Mm             | US\$ 4.00   | +Info |
| 417961 | Filter; Emi 10A                | US\$ 148.48 | +Info |
| 417962 | Motor; Stepper Linear Actuator | US\$ 315.36 | +Info |
| 417963 | Motor; Table 12Vdc             | US\$ 145.60 | +Info |
| 417964 | Pcb; Power Supply- 45W         | US\$ 162.56 | +Info |
| 417965 | Fuse 16A-500V 3Ab Fast         | US\$ 8.78   | +Info |
| 417966 | Hdw; Circuit Breaker           | US\$ 15.36  | +Info |
| 417967 | Relay; Timer- Ecm Iv           | US\$ 70.40  | +Info |
| 417968 | Fuse; Time Lag- 12.5A- 5X20Mm  | US\$ 4.00   | +Info |
| 417969 | Relay; 30A- Dpst- 120V         | US\$ 65.92  | +Info |
| 417970 | Fuse; 10A                      | US\$ 8.55   | +Info |
| 417971 | Motor; 12Vdc- 4.3 Rpm          | US\$ 186.56 | +Info |
| 417972 | Fuse; 630Ma 5 X 20 Mm          | US\$ 3.36   | +Info |
| 417973 | Fuse; 10A- .25 X 1.25          | US\$ 4.00   | +Info |
| 417975 | Inductor- 470Uh                | US\$ 11.36  | +Info |
| 417976 | Bushing; Bronze 5/16 Id        | US\$ 4.00   | +Info |
| 417977 | Chain- .25 Pitch               | US\$ 35.52  | +Info |
| 417978 | Slide 15Mm                     | US\$ 245.28 | +Info |
| 417979 | Fitting; Barb 1/8              | US\$ 3.68   | +Info |
| 417980 | Fitting Strait 1/8-27 Nyl      | US\$ 4.00   | +Info |
| 417981 | Fitting Plug 1/8 Npt Centurion | US\$ 4.00   | +Info |
| 417982 | Solenoid Valve- 12Vdc          | US\$ 82.08  | +Info |
| 417983 | Cam; Vpc Lift                  | US\$ 39.68  | +Info |
| 417984 | Tubing- Silicone.156Id .094Wal | US\$ 3.52   | +Info |
| 417985 | Fitting; 1/4 Cross Tee         | US\$ 3.68   | +Info |
| 417986 | Fitting- Vent Brass            | US\$ 9.22   | +Info |
| 417987 | Fitting- 1/8Npt X .25 Quick    | US\$ 9.54   | +Info |
| 417988 | Fitting- 1/8Npt X .25 Quick Y  | US\$ 16.48  | +Info |
| 417989 | Fitting- Ccf- reducer          | US\$ 32.16  | +Info |
| 417990 | Valve Needle- 1/8 Npt          | US\$ 41.76  | +Info |
| 417991 | Fitting; 1/8 Npt .125 Quick    | US\$ 9.54   | +Info |
| 417992 | reducer Connector              | US\$ 4.00   | +Info |
| 417993 | Connector- Type R Male         | US\$ 10.26  | +Info |
| 417994 | Connector- Type R Female       | US\$ 12.00  | +Info |
| 417995 | Fitting; Male Elbow- 1/8 Npt   | US\$ 9.18   | +Info |
| 417996 | Tubing- 6Mm Od X 4Mm Id        | US\$ 4.00   | +Info |
| 417997 | Filter- Regulator Q50-Qex      | US\$ 179.68 | +Info |
| 417998 | Fitting- Barbed- Maxvac        | US\$ 5.00   | +Info |
| 417999 | Casting; Adjustable- Cb        | US\$ 11.36  | +Info |
| 418000 | Valve; Solenoid- Pressing      | US\$ 241.92 | +Info |
| 418001 | Tubing .125 Od X .062 Id Pvc   | US\$ 4.00   | +Info |
| 418002 | Crucible                       | US\$ 33.92  | +Info |
| 418003 | Tray 8 X 8 Packaged            | US\$ 79.36  | +Info |
| 418004 | Tray; 8 X 8                    | US\$ 93.60  | +Info |
| 418005 | Door Insulation                | US\$ 38.88  | +Info |

|        |                                |             |       |
|--------|--------------------------------|-------------|-------|
| 418006 | Shelf; 1750                    | US\$ 462.56 | +Info |
| 418007 | Rod; Plunger- Pellet           | US\$ 64.00  | +Info |
| 418008 | Washer- Shoulder- Ceramic      | US\$ 12.96  | +Info |
| 418009 | Tray; Plunger- Opc             | US\$ 45.60  | +Info |
| 418010 | Base; Ccfii Door Insulation    | US\$ 58.08  | +Info |
| 418011 | Cap- Ccfii Door Insulation     | US\$ 22.24  | +Info |
| 418012 | Mirror; 2 In 1                 | US\$ 25.12  | +Info |
| 418013 | Rod; Plunger- 5 Gram           | US\$ 45.60  | +Info |
| 418014 | Overlay- Front Panel 2-525     | US\$ 41.28  | +Info |
| 418015 | Label- Caution Hot Surface     | US\$ 4.75   | +Info |
| 418021 | Overlay; Us 19H Ver C          | US\$ 13.44  | +Info |
| 418022 | Overlay; Us 28H Ver C          | US\$ 17.28  | +Info |
| 418023 | Overlay- Model 28X             | US\$ 35.36  | +Info |
| 418024 | Overlay- Model 104X            | US\$ 157.76 | +Info |
| 418025 | Label; Caution Symbol          | US\$ 3.84   | +Info |
| 418027 | Nameplate; Cerampress Q50      | US\$ 18.56  | +Info |
| 418028 | Nameplate; Centurion Q50       | US\$ 10.80  | +Info |
| 418029 | Label; Caution- High Inten Lgt | US\$ 3.52   | +Info |
| 418030 | Membrane Switch Ceram-S        | US\$ 60.00  | +Info |
| 418031 | Knob- .500 Black               | US\$ 4.00   | +Info |
| 418032 | Knob- Timer Us. Ver. C         | US\$ 4.00   | +Info |
| 418033 | Knob- Encoder                  | US\$ 50.72  | +Info |
| 418034 | Spring- .500 Od                | US\$ 4.64   | +Info |
| 418036 | Spring- Ext. 550- Muffle       | US\$ 10.62  | +Info |
| 418037 | Spring- Door Support- Sst      | US\$ 9.68   | +Info |
| 418038 | Spru Base- 3 Inch              | US\$ 34.40  | +Info |
| 418039 | Strain Relief- U.S.            | US\$ 7.65   | +Info |
| 418040 | Tubing- Vinyl 1/4 Id           | US\$ 4.00   | +Info |
| 418041 | Handle- Vpm                    | US\$ 4.75   | +Info |
| 418042 | Tubing; red Silicone           | US\$ 4.00   | +Info |
| 418043 | Heater; 40W- 240V              | US\$ 43.68  | +Info |
| 418044 | Heater; 60W- 240V              | US\$ 43.68  | +Info |
| 418045 | Heater; 110W- 240V             | US\$ 43.68  | +Info |
| 418046 | Heater; 200W 240V              | US\$ 70.24  | +Info |
| 418047 | Gasket; Vacuum Sealing         | US\$ 8.78   | +Info |
| 418048 | Ring Former; 100 Gram          | US\$ 12.32  | +Info |
| 418049 | Ring Former; 200 Gram          | US\$ 38.40  | +Info |
| 418051 | Ring Former; 200Gr- Tube       | US\$ 13.44  | +Info |
| 418053 | Ring Former; 200Gr- Tube- Blue | US\$ 13.76  | +Info |
| 418054 | Ring Former; 300Gr- Tube       | US\$ 14.72  | +Info |
| 418055 | Ring Former; 300Gr- Base       | US\$ 14.72  | +Info |
| 418056 | Spru Base; Wide                | US\$ 60.00  | +Info |
| 418058 | O-Ring- Muffle Top             | US\$ 17.12  | +Info |
| 418059 | Plug- Usb                      | US\$ 4.00   | +Info |
| 418060 | Beaker- 600MI Boxed            | US\$ 22.56  | +Info |
| 418061 | Shelf- Qex                     | US\$ 97.76  | +Info |
| 418062 | Spring Retainer- Cergo         | US\$ 10.62  | +Info |
| 418063 | Bolt; Shoulder- Cergo          | US\$ 16.32  | +Info |
| 418064 | Bar; Arm Support- Cergo        | US\$ 40.96  | +Info |

|        |                                |             |       |
|--------|--------------------------------|-------------|-------|
| 418066 | Door- Finishing- Ceramfire     | US\$ 174.40 | +Info |
| 418067 | Serv; Cushion Rubber           | US\$ 9.22   | +Info |
| 418068 | Serv; O Ring                   | US\$ 4.00   | +Info |
| 418069 | Serv; Cap Seal                 | US\$ 20.32  | +Info |
| 418070 | Serv; Cylinder Seal            | US\$ 3.52   | +Info |
| 418071 | Serv; O-Ring                   | US\$ 11.20  | +Info |
| 418072 | Serv; Front Cover              | US\$ 9.22   | +Info |
| 418073 | Serv; Valve Flapper            | US\$ 4.00   | +Info |
| 418074 | Serv; Silencer                 | US\$ 17.92  | +Info |
| 418075 | Serv; Cylinder                 | US\$ 11.70  | +Info |
| 418076 | Serv; Plate                    | US\$ 17.92  | +Info |
| 418077 | Serv; Valve Keeper Strip       | US\$ 4.00   | +Info |
| 418078 | Manual- Centurion Service      | US\$ 42.88  | +Info |
| 418079 | Instr; Crucible Adaptor        | US\$ 19.04  | +Info |
| 418080 | Bag;Shipping #6 Maillite 12X19 | US\$ 4.48   | +Info |
| 418081 | Box- 20-1/4 X 17 X 16          | US\$ 19.52  | +Info |
| 418082 | Box; 21.5 X 21.5 X 21.75       | US\$ 24.16  | +Info |
| 418083 | Muffle Support- 550            | US\$ 8.10   | +Info |
| 418084 | Insert- Foam- 4 Muffle         | US\$ 4.00   | +Info |
| 418085 | Bag- Shipping #2 Jiffy         | US\$ 4.00   | +Info |
| 418086 | Packing Support- L/R -550      | US\$ 92.48  | +Info |
| 418087 | Box- 25.9 X 17.9 X 19.8 Cergo  | US\$ 34.40  | +Info |
| 418088 | Packng Foam; Maxvac            | US\$ 46.08  | +Info |
| 418089 | Box; 16 X 12 X 10              | US\$ 9.00   | +Info |
| 418090 | Serv; Packing Set- Touch & Prs | US\$ 139.20 | +Info |
| 418091 | Serv; Box- Touch And Press     | US\$ 60.00  | +Info |
| 418092 | Box; 2 In 1                    | US\$ 17.60  | +Info |
| 418093 | Packing Support; Set- 2 In 1   | US\$ 70.40  | +Info |
| 418094 | Packing Set; Epu li            | US\$ 92.16  | +Info |
| 418095 | Bag; Plastic 43X 48            | US\$ 4.00   | +Info |
| 418098 | Tray- Small Burnout T-845      | US\$ 30.88  | +Info |
| 418099 | Plug- Banana                   | US\$ 4.80   | +Info |
| 418100 | Resistor- 1K Ohm .50W Carbon   | US\$ 0.02   | +Info |
| 418101 | Transistor- Pnp 2N3906         | US\$ 4.00   | +Info |
| 418102 | Washer; Fiberglass             | US\$ 4.00   | +Info |
| 418103 | Pwr Crd-250V Euro 130/550 Cent | US\$ 11.52  | +Info |
| 418104 | Pwr Crd 120V 20A Nema 5-20P    | US\$ 22.08  | +Info |
| 418105 | Line Cord; Glidewell Qex       | US\$ 26.08  | +Info |
| 418106 | Cap. .1Mf 400V Poly Film       | US\$ 4.00   | +Info |
| 418108 | Tube- Plain                    | US\$ 4.75   | +Info |
| 418109 | Screw; Teflon                  | US\$ 3.52   | +Info |
| 418110 | O-Ring- .208 Id                | US\$ 4.00   | +Info |
| 418111 | O-Ring-Approx-0.364 Dia.       | US\$ 4.00   | +Info |
| 418112 | Bushing; Strain Relief         | US\$ 4.00   | +Info |
| 418113 | Ic- Dual Op Amp Lm358          | US\$ 4.75   | +Info |
| 418114 | Diode; Bridge 1A 600 Piv       | US\$ 4.00   | +Info |
| 418115 | Rubber Bumper; Self Stick      | US\$ 4.00   | +Info |
| 418116 | Washer- Teflon- .375 Id        | US\$ 4.00   | +Info |
| 418117 | Lamp- red Pilot 115V           | US\$ 3.52   | +Info |

|        |                                |             |       |
|--------|--------------------------------|-------------|-------|
| 418118 | Triac- 25A 400V                | US\$ 60.00  | +Info |
| 418119 | Ceramic- Tray T-900            | US\$ 11.36  | +Info |
| 418120 | Gasket- Vacuum Sealing         | US\$ 9.00   | +Info |
| 418121 | Bushing; Flip-Lok              | US\$ 4.75   | +Info |
| 418122 | Equipment Service Labor        | US\$ 168.32 | +Info |
| 418123 | Manual Service Charge          | US\$ 22.40  | +Info |
| 418127 | Door Insul. Spring- 130        | US\$ 38.72  | +Info |
| 418128 | Tray Kit- T-900                | US\$ 30.88  | +Info |
| 418132 | Strap- Muffle                  | US\$ 21.44  | +Info |
| 418134 | Crucible Clip                  | US\$ 19.68  | +Info |
| 418135 | Counter Balance Weight         | US\$ 48.80  | +Info |
| 418136 | Plastic Bezel 3Qt              | US\$ 33.44  | +Info |
| 418138 | Perforated Pan- 6 Qt           | US\$ 115.52 | +Info |
| 418139 | Perforated Pan- 11 Qt          | US\$ 155.36 | +Info |
| 418140 | Beaker Ring; 400MI             | US\$ 12.64  | +Info |
| 418141 | Beaker Ring- 250MI             | US\$ 12.64  | +Info |
| 418142 | Exhause Port Assy- 2-1350A     | US\$ 0.02   | +Info |
| 418143 | Pivot Linkage; Centurion       | US\$ 28.48  | +Info |
| 418144 | Pivot Arm; Upper- Centurion    | US\$ 71.04  | +Info |
| 418145 | Socket Assy- 220/240V Cord     | US\$ 43.52  | +Info |
| 418146 | Wire Assy; Muffle- Centurion   | US\$ 28.00  | +Info |
| 418147 | Thermocouple Harness Centurion | US\$ 56.64  | +Info |
| 418148 | Pivot Arm; Centurion- Lower    | US\$ 97.60  | +Info |
| 418149 | Centurion Hardware Kit         | US\$ 38.72  | +Info |
| 418150 | Socket Assy- 220V 3-Stage      | US\$ 40.16  | +Info |
| 418151 | Adapter Plate- M/2-525 220V    | US\$ 23.52  | +Info |
| 418153 | Door; Latch Assy- Neycraft     | US\$ 27.04  | +Info |
| 418155 | Door Bottom- 130               | US\$ 14.08  | +Info |
| 418156 | Door- 130                      | US\$ 60.00  | +Info |
| 418157 | Door Insulation- 130           | US\$ 80.48  | +Info |
| 418158 | Exhaust Port- Ser. Iii         | US\$ 28.96  | +Info |
| 418159 | Door- 550 Painted              | US\$ 58.88  | +Info |
| 418160 | Door Bottom- 550               | US\$ 11.84  | +Info |
| 418161 | Cabinet Assy- 550- Painted     | US\$ 262.72 | +Info |
| 418162 | Front Panel- 550               | US\$ 136.80 | +Info |
| 418163 | Control Drawer- A-550          | US\$ 71.04  | +Info |
| 418164 | Heatshield- 550                | US\$ 40.80  | +Info |
| 418166 | Strap- Muffle -550             | US\$ 11.25  | +Info |
| 418167 | Wire Assy- Door Sw             | US\$ 14.08  | +Info |
| 418168 | Control Drawer Assy-3-550      | US\$ 105.28 | +Info |
| 418171 | Wraparound Assy- 1750          | US\$ 462.56 | +Info |
| 418172 | Front Panel- 1750              | US\$ 231.36 | +Info |
| 418173 | Service; Muffle Assy-130- 230V | US\$ 578.24 | +Info |
| 418174 | Service Plate A-130/23.Ohms    | US\$ 170.40 | +Info |
| 418175 | Muffle- 550 100/230V Unboxed   | US\$ 736.00 | +Info |
| 418176 | Bar- Door Spacer               | US\$ 10.26  | +Info |
| 418177 | Cord- Sac- 250V-20A            | US\$ 62.40  | +Info |
| 418178 | Cord Assy- 32A                 | US\$ 231.36 | +Info |
| 418181 | Counterbalance- Ccf Service    | US\$ 108.48 | +Info |

|        |                                |             |       |
|--------|--------------------------------|-------------|-------|
| 418182 | Heater Thermal Switch Assy     | US\$ 91.20  | +Info |
| 418183 | Pcb Assy; 300 Control Mod- Grn | US\$ 157.44 | +Info |
| 418184 | Cabinet Assy; 550Pd-550A-3-400 | US\$ 336.32 | +Info |
| 418185 | Door- 3-550Pd                  | US\$ 168.32 | +Info |
| 418187 | Muffle Qrtz Slv Window 230V    | US\$ 711.04 | +Info |
| 418188 | Door Sprng Insulation Stainles | US\$ 29.12  | +Info |
| 418189 | Bottom Wraparound- Q50         | US\$ 89.44  | +Info |
| 418191 | Wraparound- Front/Sides Q50    | US\$ 231.36 | +Info |
| 418192 | Wraparound- Top/Back Q50       | US\$ 231.36 | +Info |
| 418193 | Brkt- Valve Centurion Q100     | US\$ 22.24  | +Info |
| 418194 | Cover; Rear Column- White      | US\$ 54.24  | +Info |
| 418195 | Muffle- Qrtz Sleeve 120V- Q50  | US\$ 585.14 | +Info |
| 418197 | Pk d- Muffle Qrtz Slv Win 120V | US\$ 736.00 | +Info |
| 418198 | Fan Duct Assy- Air Exch        | US\$ 199.84 | +Info |
| 418200 | Fan Assy- Air Exch             | US\$ 231.36 | +Info |
| 418202 | Brkt- Fan Adaptor              | US\$ 33.28  | +Info |
| 418203 | Kit; Ring Former- 100 Gram     | US\$ 88.00  | +Info |
| 418204 | Kit; Ring Former- 200 Gram     | US\$ 108.80 | +Info |
| 418205 | Potentiometer Assy; Miniglaze  | US\$ 87.52  | +Info |
| 418206 | Socket Assy; 220/240V- Cergo   | US\$ 87.52  | +Info |
| 418208 | Pivot Arm; Lower- Cergo        | US\$ 95.36  | +Info |
| 418209 | Door Insulation- Pk d- Cergo   | US\$ 113.92 | +Info |
| 418210 | Assy- Lcd Display              | US\$ 566.72 | +Info |
| 418211 | Assy; Muffle Wire              | US\$ 10.08  | +Info |
| 418212 | Serv; Muffle Assy-Cergopr 120  | US\$ 872.64 | +Info |
| 418213 | Maxvac Pump- 120V              | US\$ 853.12 | +Info |
| 418215 | Wraparound;Bottom-Painted-Qex  | US\$ 332.32 | +Info |
| 418216 | Enclsure; Top Cerampress Q50   | US\$ 500.96 | +Info |
| 418217 | Enclosur;Top-Paint- Press Qex  | US\$ 482.24 | +Info |
| 418218 | Enclosure; Top- Painted- Qex   | US\$ 436.80 | +Info |
| 418219 | Tray Assy- Firing- 2.75 Round  | US\$ 48.00  | +Info |
| 418220 | Bracket; Filter/Reg            | US\$ 25.76  | +Info |
| 418221 | Pcb Assy; Card- Qex            | US\$ 110.88 | +Info |
| 418222 | Pcb Assy; Encoder- Qex         | US\$ 98.24  | +Info |
| 418223 | Column Cover- Press Qex- Paint | US\$ 60.00  | +Info |
| 418224 | Accy Kit; Cerampress Qex       | US\$ 410.08 | +Info |
| 418225 | Accy Kit; Centurion Qex        | US\$ 315.36 | +Info |
| 418226 | Memory Card; Backup- Qex       | US\$ 41.76  | +Info |
| 418227 | Serv; Muffle- Qex/Strato 120V  | US\$ 904.16 | +Info |
| 418228 | Kit;Filter/Reg.- Qex 120V      | US\$ 232.80 | +Info |
| 418229 | Heatshield; Q Series           | US\$ 43.39  | +Info |
| 418230 | Memory Card; Excelsior- Qex    | US\$ 45.60  | +Info |
| 418231 | Memory Card; Incer- Qex        | US\$ 45.60  | +Info |
| 418232 | Accy Kit; Neytech Cd Rom- Qex  | US\$ 133.12 | +Info |
| 418233 | Card- Special Operating        | US\$ 71.84  | +Info |
| 418234 | Accy Kit; Special- Neytech Qex | US\$ 47.84  | +Info |
| 418235 | Cabinet Assy; -550- Purchased  | US\$ 326.08 | +Info |
| 418237 | Door Insul- Pk d- Stratopress  | US\$ 116.96 | +Info |
| 418238 | Cap- Door Insulation           | US\$ 104.00 | +Info |



|        |                                 |             |       |
|--------|---------------------------------|-------------|-------|
| 418239 | Thermocouple Assy; Brazil Q200  | US\$ 273.44 | +Info |
| 418241 | Cable Assy;Cntrl Suction Bypas  | US\$ 168.32 | +Info |
| 418242 | Thermocouple Assy; Gldewll Qex  | US\$ 459.20 | +Info |
| 418243 | Fan Assy; 2 In 1                | US\$ 84.64  | +Info |
| 418244 | Thermistor Assy; 2 In 1         | US\$ 85.60  | +Info |
| 418245 | Assy; Mirror- 2 In 1            | US\$ 46.56  | +Info |
| 418246 | Bulb Assy; 3/Pk- 2-In-1         | US\$ 123.04 | +Info |
| 418247 | Service; Door Motor Assy- 2In1  | US\$ 252.32 | +Info |
| 418248 | Pcb Assy; Epu li- 230V          | US\$ 959.84 | +Info |
| 418249 | Wire Assy; Table Sensor- Epuui  | US\$ 77.28  | +Info |
| 418250 | Socket Assy; 200-240V- Epu li   | US\$ 128.80 | +Info |
| 418251 | Memory Card; Finesse- Qex       | US\$ 45.60  | +Info |
| 418252 | Memory Card; Ceramco- Qex       | US\$ 45.60  | +Info |
| 418254 | Flexible Ring Former- 200Gram   | US\$ 28.64  | +Info |
| 418255 | Flexible Ring Former- Set       | US\$ 48.80  | +Info |
| 418256 | Serv; Ic Assy- Q50              | US\$ 273.44 | +Info |
| 418257 | Serv; Ic Assy- Qex              | US\$ 283.84 | +Info |
| 418258 | Kit; Ring Former- 200Gr- Wide   | US\$ 100.80 | +Info |
| 418259 | Ring Plunger; W-1               | US\$ 81.28  | +Info |
| 418260 | Plunger Tray; W/N Combo-1       | US\$ 66.08  | +Info |
| 418261 | Serv; Mmtp Polyimide Tube- Blue | US\$ 53.76  | +Info |
| 418264 | Bulk Pk ; 7200506- 10X          | US\$ 583.20 | +Info |
| 418266 | Program Card; Enterra           | US\$ 41.76  | +Info |
| 418267 | Memory Card; Eclipse Junior     | US\$ 41.76  | +Info |
| 418268 | Bulb; 3/Pk- Eclipse Junior      | US\$ 119.20 | +Info |
| 418269 | Assy; Top Encl- Ceramco 7.0     | US\$ 95.52  | +Info |
| 418270 | Enterra- 120V                   | US\$ 0.02   | +Info |
| 418271 | Socket Assy; 230V- 550          | US\$ 22.24  | +Info |
| 418272 | Assy; Potentiometer             | US\$ 66.72  | +Info |
| 418273 | Bottom Wraparound- 7.0          | US\$ 89.44  | +Info |
| 418274 | Kit; Socket Retrofit- 550/550A  | US\$ 236.00 | +Info |
| 418275 | Heat Block; Painted- Radica     | US\$ 853.12 | +Info |
| 418277 | Cabinet; Bottom- Radica         | US\$ 393.28 | +Info |
| 418279 | Wire Assy; Led                  | US\$ 22.24  | +Info |
| 418282 | Serv; Table- Denture-Epu li     | US\$ 413.76 | +Info |
| 418283 | Top Enclosure Mtg Brkt- Cer.T   | US\$ 189.44 | +Info |
| 418284 | Bottom Cover Plate Ceramfire S  | US\$ 73.92  | +Info |
| 418285 | Bottom Wraparound Ceramfire S   | US\$ 94.40  | +Info |
| 418286 | Column Cover- Ceramfire S       | US\$ 43.39  | +Info |
| 418287 | Chamber Assy- Ceramfire         | US\$ 223.36 | +Info |
| 418288 | Harness Assy Chamber            | US\$ 153.76 | +Info |
| 418289 | Socket Assy Pump                | US\$ 49.76  | +Info |
| 418290 | Socket Assy 230V                | US\$ 62.24  | +Info |
| 418291 | Wire Assy Cord/Switch           | US\$ 80.96  | +Info |
| 418292 | Motor Assy 12Vdc Ceramfire      | US\$ 332.16 | +Info |
| 418293 | Valve Kit Ceramfire             | US\$ 276.64 | +Info |
| 418294 | Door Insul. Pk S/T (Ceramfire)  | US\$ 72.48  | +Info |
| 418295 | Serv; Muffle 120V Ceramfire     | US\$ 512.16 | +Info |
| 418296 | Serv; Muffle 230V Ceramfire     | US\$ 512.16 | +Info |

|        |                                |             |       |
|--------|--------------------------------|-------------|-------|
| 418297 | Muffle Term Kit Ceramfire      | US\$ 74.88  | +Info |
| 418298 | Serv; Thermocouple Ceramfire   | US\$ 84.32  | +Info |
| 418299 | Shelf Cover Plate Assy T/P     | US\$ 70.56  | +Info |
| 418300 | Firing Platform                | US\$ 149.12 | +Info |
| 418301 | Phoenix Calibration Platform   | US\$ 496.64 | +Info |
| 418302 | Retain Ring For 1/4 Shaft      | US\$ 4.00   | +Info |
| 418303 | O Ring                         | US\$ 24.64  | +Info |
| 418304 | Platform Carrier Seal          | US\$ 4.00   | +Info |
| 418305 | Thermocouple Assembly          | US\$ 555.68 | +Info |
| 418306 | Silver Calibration Wire        | US\$ 55.20  | +Info |
| 418307 | Urethane Idler Pulley          | US\$ 57.60  | +Info |
| 418308 | Washer- Friction               | US\$ 9.90   | +Info |
| 418309 | Nut- 10-32 Brass               | US\$ 4.00   | +Info |
| 418310 | Nut- 1/4-20 Hex Kep            | US\$ 4.00   | +Info |
| 418311 | Screw; 6-32 Panhead Phillips   | US\$ 4.00   | +Info |
| 418312 | Screw #6 X .50 Blk Th          | US\$ 4.00   | +Info |
| 418313 | Screw- #10-32 X 1/2 Ext Sems   | US\$ 4.00   | +Info |
| 418314 | Screw- 10-32 X .38 Sems. Sst   | US\$ 3.52   | +Info |
| 418315 | Box; 12 X 12 X 12              | US\$ 4.00   | +Info |
| 418316 | Packing Filler                 | US\$ 61.92  | +Info |
| 418317 | Butt Splice- 10-12Ga           | US\$ 4.00   | +Info |
| 418319 | Spry;Centrc Ocdsl-Wht-1Can Haz | US\$ 33.60  | +Info |
| 418327 | Waxpencil- Tip #11 (3\Pk)      | US\$ 47.52  | +Info |
| 418328 | Waxpencil- Tip #14(3\Pk)       | US\$ 47.52  | +Info |
| 418329 | Waxpencil- Black               | US\$ 168.32 | +Info |
| 418330 | Waxpencil- White               | US\$ 168.32 | +Info |
| 418331 | Cleaner; Wavesolder Machine    | US\$ 20.64  | +Info |
| 418332 | Pin; Honeycomb                 | US\$ 21.00  | +Info |
| 418334 | Crucible Adaptor               | US\$ 87.52  | +Info |
| 418337 | Extra Small Mixing Bowl Comp   | US\$ 295.68 | +Info |
| 418338 | Extra Large Mixing Bowl Comp   | US\$ 350.08 | +Info |
| 418339 | Holder; Crucible 23510052      | US\$ 41.28  | +Info |
| 418340 | Crucible; Universal- 23510054  | US\$ 69.28  | +Info |
| 418341 | Casting Rings; 1X              | US\$ 25.76  | +Info |
| 418343 | Small Mixing Bowl Complete     | US\$ 295.68 | +Info |
| 418344 | Large Mixing Bowl Complete     | US\$ 295.68 | +Info |
| 418347 | F-1 Milling Mach Model Table   | US\$ 909.28 | +Info |
| 418348 | Instru; Wax Probe As2          | US\$ 294.40 | +Info |
| 418349 | Instrument- Mod Knife Bs2      | US\$ 371.04 | +Info |
| 418350 | Instrument- Mod Knife Lg C2    | US\$ 560.32 | +Info |
| 418351 | Instru; Wax Spoon D2           | US\$ 359.68 | +Info |
| 418354 | Optivest Liquid Only-5000 MI   | US\$ 123.20 | +Info |
| 418355 | Sm Mixing Bwl Comp Mvcompact   | US\$ 294.56 | +Info |
| 418356 | Lg Mixing Bowl Comp Mvcompact  | US\$ 294.56 | +Info |
| 418357 | Filter- Multivac Compac        | US\$ 11.25  | +Info |
| 418358 | Extra Sm Mx Bwl Comp Mvcompc   | US\$ 294.56 | +Info |
| 418359 | Ex Large Mix Bwl Comp Mvcompac | US\$ 324.96 | +Info |
| 418360 | Filter; Internal               | US\$ 54.56  | +Info |
| 418361 | Sealing Start Unit 53005102    | US\$ 32.32  | +Info |

|        |                                 |             |       |
|--------|---------------------------------|-------------|-------|
| 418362 | Filter; Multivac Compact        | US\$ 32.32  | +Info |
| 418363 | Table Plate W/Assy Material     | US\$ 65.76  | +Info |
| 418364 | Brakes With Assmby Material     | US\$ 326.08 | +Info |
| 418365 | Foil Keys                       | US\$ 265.28 | +Info |
| 418367 | Assy; Bowl Only- Small Mixing   | US\$ 256.96 | +Info |
| 418368 | Assy; Bowl Only- Large Mixing   | US\$ 301.60 | +Info |
| 418369 | Seal; Oil Reservoir-Multivac S  | US\$ 12.48  | +Info |
| 418370 | Suction Tube W/1 Filter Pc      | US\$ 140.48 | +Info |
| 418371 | O Ring-Small For Filter Piece   | US\$ 9.45   | +Info |
| 418372 | Control Element F/Green Phbton  | US\$ 92.32  | +Info |
| 418373 | Fastening Clip 4 Vacuum Meter   | US\$ 9.90   | +Info |
| 418374 | Knob W/Valve Needle             | US\$ 49.28  | +Info |
| 418375 | Vent Valve W/Washer & Nut       | US\$ 97.76  | +Info |
| 418376 | Ring For Timer                  | US\$ 11.20  | +Info |
| 418377 | Serv; Motor Kit- Cergo          | US\$ 336.32 | +Info |
| 418378 | Serv; Display Pcb- Cergo        | US\$ 777.92 | +Info |
| 418379 | Serv; Pcb Encoder Crd-Cergo     | US\$ 925.12 | +Info |
| 418380 | Serv; Thermocouple Assy- Cergo  | US\$ 685.60 | +Info |
| 418381 | Serv; Membrn Swtch-Cercn Brain  | US\$ 384.96 | +Info |
| 418384 | Engine;Wheel Rough Spndl-Cercn  | US\$ 99.68  | +Info |
| 418385 | Engine;Wheel Finsh Spndl-Cercn  | US\$ 182.88 | +Info |
| 418387 | Switches; Code- Cercn           | US\$ 351.52 | +Info |
| 418388 | Bolts; Fixing Set- Sm Material  | US\$ 698.72 | +Info |
| 418390 | Propelled Turning Unit; Cercn   | US\$ 928.96 | +Info |
| 418391 | Unit;Whl Trn-Sm-Groov Bll Bear  | US\$ 188.96 | +Info |
| 418392 | Belt; Gt Mr Toothed 3Mr-120-9   | US\$ 131.20 | +Info |
| 418394 | Pcb; Oh Control                 | US\$ 595.84 | +Info |
| 418397 | Fuse; Micro- 2.0A Slow Acting   | US\$ 37.28  | +Info |
| 418398 | Pcb; Baking Tarpaulin           | US\$ 559.68 | +Info |
| 418399 | Pcb; Piggyback                  | US\$ 472.16 | +Info |
| 418406 | Foil; Shielding                 | US\$ 198.56 | +Info |
| 418408 | Wall; Rear- Sk 101449           | US\$ 700.32 | +Info |
| 418409 | Pope; Exhaust- 8314             | US\$ 309.92 | +Info |
| 418410 | Pcb; Exhaust                    | US\$ 146.40 | +Info |
| 418412 | Girder; Sheet Metal- Left       | US\$ 277.76 | +Info |
| 418413 | Girder; Sheet Metal- Right      | US\$ 277.76 | +Info |
| 418414 | Pcb; Base- Right                | US\$ 239.20 | +Info |
| 418415 | Pcb; Base- Left                 | US\$ 239.20 | +Info |
| 418416 | Disc; Cam                       | US\$ 453.76 | +Info |
| 418417 | Magnet; Bolting Device          | US\$ 773.92 | +Info |
| 418418 | Switch; Snap                    | US\$ 167.36 | +Info |
| 418419 | Switch; Sheet Metal             | US\$ 242.08 | +Info |
| 418420 | Hood; Hinge                     | US\$ 180.00 | +Info |
| 418421 | Camps;Few Sliding Bearing Hood  | US\$ 142.24 | +Info |
| 418422 | Counterbalance; Torsion Spring  | US\$ 404.96 | +Info |
| 418423 | Counterbalance; Attchmnt- Left  | US\$ 132.00 | +Info |
| 418424 | Counterbalance; Attchmnt- Right | US\$ 132.00 | +Info |
| 418425 | Lcd; Complete-Serial Interface  | US\$ 386.08 | +Info |
| 418427 | Laser; Carriers                 | US\$ 306.08 | +Info |

|        |                                |             |       |
|--------|--------------------------------|-------------|-------|
| 418429 | Laser; Shutter Pcb             | US\$ 145.44 | +Info |
| 418431 | Sensor; Proximity X+           | US\$ 876.64 | +Info |
| 418432 | Sensor; Proximity X-/Z-        | US\$ 942.72 | +Info |
| 418433 | Sensor; Proximity Y+           | US\$ 778.56 | +Info |
| 418435 | Sensor; Proximity Z+           | US\$ 903.04 | +Info |
| 418436 | Pulley; Spindle 60-3Mr         | US\$ 245.28 | +Info |
| 418437 | Pulley; Motor 20-3Mr           | US\$ 181.76 | +Info |
| 418438 | Pulley; Gt Mr- 3Mr-270-9       | US\$ 130.88 | +Info |
| 418440 | Pcb; Xyz                       | US\$ 229.44 | +Info |
| 418441 | Holder; Turning Unit           | US\$ 387.52 | +Info |
| 418442 | Cable; Lambda Dc Mains- B2     | US\$ 166.72 | +Info |
| 418443 | Cable; Cosel Dc Mains- B2      | US\$ 162.56 | +Info |
| 418444 | Cable; Lambda Ac Mains- B1     | US\$ 139.68 | +Info |
| 418445 | Cable; Cosel Ac Mains- B1      | US\$ 139.68 | +Info |
| 418446 | Cable; X/Y Axis- B3-B4         | US\$ 314.56 | +Info |
| 418447 | Cable; Z Axis- B5              | US\$ 293.60 | +Info |
| 418448 | Cable; Fan Connecting- B6      | US\$ 207.36 | +Info |
| 418449 | Cable; Vac Clnr- Internal B7   | US\$ 359.04 | +Info |
| 418450 | Cable; Disk Drive- Cpl 13730   | US\$ 183.68 | +Info |
| 418451 | Cable;Shroud Mtr-Cvr Mgnt B10  | US\$ 224.96 | +Info |
| 418452 | Cable; Turning Unit Power B20  | US\$ 141.28 | +Info |
| 418453 | Cable;Pggybck-Shroud Swtch B11 | US\$ 221.76 | +Info |
| 418454 | Cable;Relay Bd-Shroud Swtc B12 | US\$ 211.84 | +Info |
| 418455 | Cable; Laser B13               | US\$ 252.64 | +Info |
| 418456 | Cable; Lc Display 2- B15       | US\$ 191.20 | +Info |
| 418457 | Cable; Lc Display 1- B21       | US\$ 269.76 | +Info |
| 418458 | Cable; Pc Mains- B17           | US\$ 199.84 | +Info |
| 418459 | Cable; Laser Shutter- B9       | US\$ 213.28 | +Info |
| 418460 | Cable; Scsi Iii- 68 Pol- 13857 | US\$ 224.00 | +Info |
| 418461 | Cable; Scsi Iii- 68 Pol-13856  | US\$ 343.04 | +Info |
| 418462 | Switch; Bimetal Fan Cutoff     | US\$ 339.20 | +Info |
| 418463 | Contactora; Ac                 | US\$ 771.36 | +Info |
| 418464 | Fan; Cooling                   | US\$ 886.24 | +Info |
| 418465 | Switch; Micro                  | US\$ 345.60 | +Info |
| 418468 | Wire Harness; Fan              | US\$ 274.88 | +Info |
| 418470 | Filter; Emi                    | US\$ 877.60 | +Info |
| 418471 | Varistor; 230V                 | US\$ 135.36 | +Info |
| 418472 | Serv; Semiconductor Fuse 20A   | US\$ 200.64 | +Info |
| 418476 | Service; Membrane Sw Cern Heat | US\$ 440.80 | +Info |
| 418478 | Seal; Cover- 2Pcs              | US\$ 145.92 | +Info |
| 418479 | Electrnc;Vac Motor Speed Cntrl | US\$ 360.00 | +Info |
| 418480 | Filter; Fine- Exchange         | US\$ 892.32 | +Info |
| 418482 | Switch; Frequency 50/60Hz      | US\$ 91.20  | +Info |
| 418483 | Latch                          | US\$ 30.40  | +Info |
| 418484 | Switch; Main 2-Pol +Signal Grn | US\$ 100.96 | +Info |
| 418485 | Socket; Connection             | US\$ 501.60 | +Info |
| 418486 | Element; Combination W/O Drawr | US\$ 150.72 | +Info |
| 418487 | Bearing; With Flanged Connctin | US\$ 222.08 | +Info |
| 418488 | Carbon Brush; Vacuum Motor     | US\$ 141.12 | +Info |

|        |                                |             |       |
|--------|--------------------------------|-------------|-------|
| 418489 | Led; Light Yel W/Cable Connect | US\$ 54.40  | +Info |
| 418490 | Mat; Sound Dampening For Cover | US\$ 193.92 | +Info |
| 418491 | Screw; Knurled Thumb           | US\$ 46.08  | +Info |
| 418492 | Drawer; W/Combination Element  | US\$ 67.52  | +Info |
| 418493 | Fuse; 6.3A/T (5 X 20)          | US\$ 9.90   | +Info |
| 418494 | Bag; Dust Collector (5/Pk)     | US\$ 312.64 | +Info |
| 418495 | Bracket; Mounting For Vac Clnr | US\$ 15.68  | +Info |
| 418496 | Latch; Hook                    | US\$ 144.64 | +Info |
| 418497 | Resistor; 60.4K-Ohms           | US\$ 21.28  | +Info |
| 418498 | Transducer; Vacuum             | US\$ 263.04 | +Info |
| 418499 | Driving Shaft                  | US\$ 462.56 | +Info |
| 418500 | Mirror Arm                     | US\$ 142.40 | +Info |
| 418502 | Adjusting Device- Complete     | US\$ 546.56 | +Info |
| 418503 | Heating Conductor Cable        | US\$ 78.08  | +Info |
| 418504 | Contact Block- Ho 1 & Ho Ts    | US\$ 263.04 | +Info |
| 418505 | V-Belt                         | US\$ 78.08  | +Info |
| 418506 | Hi Load Resist. 230V- 3-3Ohm   | US\$ 81.28  | +Info |
| 418507 | Hi Load Resist. 115V- 2-2Ohm   | US\$ 33.76  | +Info |
| 418508 | Circuit Board Anmulti4         | US\$ 588.80 | +Info |
| 418509 | Furnace Wire Complete          | US\$ 102.08 | +Info |
| 418510 | Solid State Relay-Mltcst Cmpct | US\$ 148.16 | +Info |
| 418511 | Felt Ring 16X11- 10Pcs         | US\$ 30.08  | +Info |
| 418512 | Cover Lock- Multicast Compact  | US\$ 546.56 | +Info |
| 418513 | Gs-Lifting Magnet W/Fixing Mat | US\$ 347.04 | +Info |
| 418514 | Serv;Display Mltimat/Cast Cmpt | US\$ 462.56 | +Info |
| 418515 | Plug Receiver W/Screws         | US\$ 787.52 | +Info |
| 418516 | Cable;W/Mat Assy-Multcst Cmpct | US\$ 24.16  | +Info |
| 418517 | Front Cap W/Band Pass Filter   | US\$ 162.56 | +Info |
| 418518 | Qc Calibration Platform        | US\$ 231.36 | +Info |
| 418522 | Mmc Insulation Insert          | US\$ 108.32 | +Info |
| 418523 | Mmc Top Terminal Insulation    | US\$ 64.16  | +Info |
| 418524 | Mmc Cover                      | US\$ 101.12 | +Info |
| 418525 | Mmc Firing Platform Support    | US\$ 35.04  | +Info |
| 418526 | Mmc Insulation Plate           | US\$ 4.00   | +Info |
| 418527 | Mmc Front Foil                 | US\$ 37.28  | +Info |
| 418528 | Mmc Capacitor 10 Fm            | US\$ 11.36  | +Info |
| 418529 | Mmc Firing Platform Supp. Seal | US\$ 4.00   | +Info |
| 418531 | Mmc Heat Sink                  | US\$ 58.56  | +Info |
| 418532 | Mmt&P Silicon Seal 3Mm         | US\$ 6.97   | +Info |
| 418533 | Mmt&P Silicon Seal 5Mm         | US\$ 4.00   | +Info |
| 418534 | Mmc Disk- Frequenta            | US\$ 3.68   | +Info |
| 418535 | Mmc Socket- Frequenta          | US\$ 9.68   | +Info |
| 418536 | Seal Vessel Top                | US\$ 10.80  | +Info |
| 418537 | Mmt&P O Ring Firing Platform   | US\$ 4.64   | +Info |
| 418538 | Mmt&P O Ring Simirit 2-5Mm     | US\$ 3.52   | +Info |
| 418539 | Serv; Cable Set Assy.          | US\$ 854.56 | +Info |
| 418543 | Mmtp Lwr Furnace Hsg- Pcoat    | US\$ 500.32 | +Info |
| 418544 | Mmt&P Microswitch W3           | US\$ 9.90   | +Info |
| 418545 | Mmtp Compact Ballbearing Slv   | US\$ 30.40  | +Info |

|        |                                |             |       |
|--------|--------------------------------|-------------|-------|
| 418546 | Mmtp Bulkhead Nipple           | US\$ 23.36  | +Info |
| 418547 | Mmtp Fuse Holder W/Nut         | US\$ 115.20 | +Info |
| 418548 | Mmtp Fek Cap                   | US\$ 4.64   | +Info |
| 418549 | Mmt&P Power Supply             | US\$ 297.92 | +Info |
| 418550 | Mmtp Firing P-Form Crier Seal  | US\$ 136.00 | +Info |
| 418551 | Mmtp Cooling Jacket            | US\$ 297.92 | +Info |
| 418552 | Cord; Power- T & P- 120V       | US\$ 14.72  | +Info |
| 418553 | Mmtp Pressure Disc C350        | US\$ 464.80 | +Info |
| 418554 | Mmtp Silicon Seal 5Mm#195.66   | US\$ 9.90   | +Info |
| 418555 | Mmtp Press Rod Aluoxid         | US\$ 238.40 | +Info |
| 418556 | Mmtp Press Cover- Pwder Coated | US\$ 345.44 | +Info |
| 418557 | Mmt&P Sensor(Press)            | US\$ 190.72 | +Info |
| 418558 | Mmt&P 4/2 Way Solenoid Valve   | US\$ 274.24 | +Info |
| 418559 | Mmtp Polyimide Tube- Blue      | US\$ 5.00   | +Info |
| 418560 | Mmtp Nipple G 1/8              | US\$ 11.03  | +Info |
| 418561 | Mmtp Compact Cylinder-Viton    | US\$ 254.72 | +Info |
| 418562 | Mmtp Bulkhead Coupling         | US\$ 27.04  | +Info |
| 418563 | Multimat C-Washer- Brass       | US\$ 4.00   | +Info |
| 418564 | Mmtp Thermocouple-Complete     | US\$ 262.08 | +Info |
| 418568 | Mmtp Oil Changing Kit*         | US\$ 238.40 | +Info |
| 418569 | Serv; Qrtz Muffle- 230V        | US\$ 728.16 | +Info |
| 418570 | Multimat C 115V Quartz Muffle  | US\$ 500.32 | +Info |
| 418571 | Mmtp Terminal Stud Muffle      | US\$ 40.48  | +Info |
| 418572 | Multimat C Barlan Disk 170X    | US\$ 4.00   | +Info |
| 418573 | Mmtp Solenoid Valve Block      | US\$ 313.12 | +Info |
| 418574 | Multimat C Fuse Garter         | US\$ 3.68   | +Info |
| 418575 | Multimat C Cap For Fuse Garter | US\$ 3.36   | +Info |
| 418576 | Mmtp Sync.Gear Motor-Complete  | US\$ 476.64 | +Info |
| 418577 | Mmtp Usa Pressure Rgltr-Comp   | US\$ 288.48 | +Info |
| 418578 | Mmtp Euro Pressure Rgltr-Comp  | US\$ 276.00 | +Info |
| 418579 | Multimat C Socket- Vacuum Pump | US\$ 13.12  | +Info |
| 418580 | Mmtp Firing Platform           | US\$ 128.48 | +Info |
| 418582 | Mmtp Ribe-Cap Sw5- M6          | US\$ 4.00   | +Info |
| 418583 | Mmvp Silencer                  | US\$ 43.52  | +Info |
| 418584 | Mmvp red Sealing Cap           | US\$ 5.00   | +Info |
| 418585 | Mmvp Vacuum Hose Assy          | US\$ 90.24  | +Info |
| 418586 | Mmvp Plug                      | US\$ 4.00   | +Info |
| 418587 | Multimat C Micro Switch        | US\$ 11.52  | +Info |
| 418588 | Mmc Solenoid Coil140Ohm2/2Valv | US\$ 96.80  | +Info |
| 418589 | Mmc Solenoid Coil100Ohm3/2Valv | US\$ 106.56 | +Info |
| 418591 | Mmtp Pressing Platform-Compl*  | US\$ 153.60 | +Info |
| 418593 | Mmt Capacitor For Pumps        | US\$ 52.32  | +Info |
| 418594 | Straight Sprue (13 Ga)         | US\$ 5.00   | +Info |
| 418595 | Sprue; Reservoir A) *          | US\$ 4.00   | +Info |
| 418596 | Casting Ring- Taper 1.5Dia     | US\$ 18.88  | +Info |
| 418597 | Casting Ring- Taper 1.25Dia    | US\$ 17.28  | +Info |
| 418598 | Crucible- 6Cc                  | US\$ 25.28  | +Info |
| 418599 | 100/110volOn/Off Rocker        | US\$ 20.32  | +Info |
| 418600 | Thermal Insulating Disks 3     | US\$ 39.20  | +Info |



|        |                                 |             |       |
|--------|---------------------------------|-------------|-------|
| 418601 | Quick-Cooling Sagger Tray       | US\$ 30.24  | +Info |
| 418603 | Phoenix Vac Pump Loaner 115V    | US\$ 946.24 | +Info |
| 418604 | Taper Sagger Tray Pins          | US\$ 70.08  | +Info |
| 418605 | 100V 50/60 Hz Oilless Pump      | US\$ 946.24 | +Info |
| 418608 | Burnout Comp.P&D Board 230Vref  | US\$ 799.20 | +Info |
| 418609 | Burnout Power Board 230V Refur  | US\$ 483.68 | +Info |
| 418610 | Burnout Display Board Refurb    | US\$ 315.36 | +Info |
| 418611 | Burnout Comp.P&D Board 155Vref  | US\$ 799.20 | +Info |
| 418612 | Burnout Power Board 115V Refur  | US\$ 483.68 | +Info |
| 418613 | Flask 2 Inch                    | US\$ 15.52  | +Info |
| 418614 | Flask 3 In                      | US\$ 21.12  | +Info |
| 418615 | Tube- .125 Id X .188 Od         | US\$ 4.00   | +Info |
| 418616 | Ic; Dual Op Amp                 | US\$ 4.00   | +Info |
| 418617 | Varistor; 130V Metal Oxide      | US\$ 4.00   | +Info |
| 418618 | Varistor; 250V Metal Oxide      | US\$ 4.00   | +Info |
| 418619 | Diode Bridge- 10A               | US\$ 13.44  | +Info |
| 418620 | Switch- Power                   | US\$ 15.04  | +Info |
| 418621 | Switch- Rotary                  | US\$ 13.28  | +Info |
| 418622 | Display; 10 Character Panel     | US\$ 79.84  | +Info |
| 418623 | Socket- 2 Pin W/Angle Brkt      | US\$ 3.52   | +Info |
| 418624 | Hdw; Fuse Holder                | US\$ 11.84  | +Info |
| 418625 | Fuse- 1 Amp                     | US\$ 4.00   | +Info |
| 418626 | Pivot Mfg & Plated Complete     | US\$ 16.80  | +Info |
| 418627 | Shelf- Muffle                   | US\$ 37.44  | +Info |
| 418632 | Muffle- 220V- 525/Nc Service    | US\$ 462.56 | +Info |
| 418633 | Crucible Slide Assy             | US\$ 55.84  | +Info |
| 418634 | Exhaust Port Assy               | US\$ 58.08  | +Info |
| 418635 | Band- Muffle                    | US\$ 23.84  | +Info |
| 418636 | Triac Assy Mg/2                 | US\$ 85.60  | +Info |
| 418637 | Beakers- 400 MI- Pk Of 2        | US\$ 37.44  | +Info |
| 418638 | Heatsink Starfire               | US\$ 10.80  | +Info |
| 418640 | Nut- 6-32 Acorn                 | US\$ 4.00   | +Info |
| 418641 | Screw- #6 X .25 Self Tap Ph     | US\$ 4.00   | +Info |
| 418643 | Mmt & Mmtp Upgrade Card         | US\$ 440.96 | +Info |
| 418644 | Smart Card Kit                  | US\$ 116.96 | +Info |
| 418646 | Serv; Triac- 9303015            | US\$ 31.52  | +Info |
| 418647 | Infinite Controlr 100/120V      | US\$ 30.08  | +Info |
| 418648 | Serv; Infinite Contr 220/240    | US\$ 0.02   | +Info |
| 418650 | Slide Assy Comp. Replcmnt Pa    | US\$ 340.32 | +Info |
| 418651 | Motor Hsng/Bearing Assy Kit     | US\$ 231.36 | +Info |
| 418653 | Serv;Pcb Encder Crd-Qex/Strato  | US\$ 84.16  | +Info |
| 418654 | Serv; Pcb- Cerampress Q50- 120  | US\$ 808.32 | +Info |
| 418655 | Serv; Pcb- Cerampress Q50- 230  | US\$ 808.32 | +Info |
| 418658 | Serv; Pcb Assy- Enterra/Epu Jr  | US\$ 387.04 | +Info |
| 418660 | Serv; Pcb Assy- D-Cont- 120V    | US\$ 595.68 | +Info |
| 418661 | Serv; Pcb Assy- D-Cont- 230V    | US\$ 646.08 | +Info |
| 418662 | Serv;Assy-Lcd Disp-Qex/Str/Epu  | US\$ 331.84 | +Info |
| 418663 | Serv; Pcb Assy- Radica          | US\$ 544.48 | +Info |
| 418664 | Service- Kit Mtor Sprsr Vulc.Pd | US\$ 0.02   | +Info |

|        |                                  |             |       |
|--------|----------------------------------|-------------|-------|
| 418665 | Serv; Pcb Assy- Q50              | US\$ 522.24 | +Info |
| 418666 | Serv Pcb Assy Ceramfire S        | US\$ 640.80 | +Info |
| 418667 | Returned- 57X/104X Board         | US\$ 304.80 | +Info |
| 418668 | Exchange-57X/104X Srvc 230V      | US\$ 304.80 | +Info |
| 418671 | Muffle Door Insulation Kit       | US\$ 102.24 | +Info |
| 418672 | Muffle Kit (120V) S/& Neyfire T  | US\$ 885.28 | +Info |
| 418673 | Muffle Kit (230V) S/& Neyfire T  | US\$ 885.28 | +Info |
| 418674 | Thermocouple Assembly Kit        | US\$ 225.44 | +Info |
| 418675 | Muffle Chamber Face Plate Kit    | US\$ 199.04 | +Info |
| 418676 | Linear Actuator Kit              | US\$ 340.00 | +Info |
| 418677 | Linear Actuator Cap              | US\$ 58.88  | +Info |
| 418678 | Muffle Door Plate                | US\$ 190.40 | +Info |
| 418679 | Muffle Door Plate O-Ring         | US\$ 24.32  | +Info |
| 418681 | Vacuum Solenoid Set              | US\$ 349.28 | +Info |
| 418682 | Power Supply                     | US\$ 108.00 | +Info |
| 418683 | Power Input Module               | US\$ 173.28 | +Info |
| 418684 | User Interface Module Connection | US\$ 41.76  | +Info |
| 418686 | User Interface Module Stand      | US\$ 166.88 | +Info |
| 418687 | User Interface Module Cable      | US\$ 52.80  | +Info |
| 418688 | Thermal Over Load                | US\$ 42.88  | +Info |
| 418689 | Power Cord- 120V                 | US\$ 111.36 | +Info |
| 418690 | Quick-Pour Duplic. Matl          | US\$ 190.24 | +Info |
| 418691 | Crucible; High Heat/Open Torch   | US\$ 46.24  | +Info |
| 418692 | Ceramco Brush Kit                | US\$ 279.04 | +Info |
| 418693 | Lab Kit Compl A19.941            | US\$ 370.56 | +Info |
| 418694 | Plastic Posts Yellow A11911      | US\$ 370.56 | +Info |
| 418695 | Plastic Posts red A12911         | US\$ 370.56 | +Info |
| 418696 | Plastic Posts Blu A13911         | US\$ 370.56 | +Info |
| 418697 | Plastic Posts Green A14911       | US\$ 370.56 | +Info |
| 418698 | Plastic Posts Black A15911       | US\$ 370.56 | +Info |
| 418699 | Steel Temp Posts Yellow A11901   | US\$ 370.56 | +Info |
| 418700 | Steel Temp Posts red A12901      | US\$ 370.56 | +Info |
| 418701 | Steel Temp Posts Blu A13901      | US\$ 370.56 | +Info |
| 418702 | Steel Temp Posts Black A15901    | US\$ 370.56 | +Info |
| 418703 | Drill/Reamer Yellow A11952       | US\$ 370.72 | +Info |
| 418704 | Drill/Reamer red A12952          | US\$ 370.72 | +Info |
| 418705 | Drill/Reamer Blue A13952         | US\$ 370.72 | +Info |
| 418706 | Drill/Reamer Green A14952        | US\$ 370.72 | +Info |
| 418707 | Drill/Reamer Black A15952        | US\$ 370.72 | +Info |
| 418708 | Trimmer Gt 110vol23230002        | US\$ 370.56 | +Info |
| 418709 | Cartridges 23511200              | US\$ 370.56 | +Info |
| 418710 | Prep Magazine Reprint (Min-50)   | US\$ 370.56 | +Info |
| 418711 | Tech Metal Gold Color 1-Oz. Pk   | US\$ 47.36  | +Info |
| 418712 | Hose Clamp Small                 | US\$ 4.00   | +Info |
| 418713 | Manual; Surveyor                 | US\$ 12.32  | +Info |
| 418716 | Perforated Pan- Model 136 Pk d   | US\$ 201.92 | +Info |
| 418717 | Scale; Cal Q                     | US\$ 590.72 | +Info |
| 418718 | Scale; Digital Investment        | US\$ 580.00 | +Info |
| 418719 | Mini Scale- Digital Model#1479   | US\$ 435.84 | +Info |

|        |                                |             |       |
|--------|--------------------------------|-------------|-------|
| 418720 | Quantum li Np Sldr 6 Rods      | US\$ 26.88  | +Info |
| 418734 | Wax Buttons 100/Box            | US\$ 30.88  | +Info |
| 418735 | Sprue Offset 13Ga Pk /100      | US\$ 58.56  | +Info |
| 418736 | Sprue Base; 1-3/4 (3 Pk )      | US\$ 81.76  | +Info |
| 418737 | Casting Ring- Taper 2 1/Pk     | US\$ 25.28  | +Info |
| 418738 | Casting Ring- Taper 2.5 1/Pk   | US\$ 32.80  | +Info |
| 418739 | Casting Ring- TaprD 1.25 3/Pk  | US\$ 60.64  | +Info |
| 418740 | Casting Ring- TaprD 1.5 3/Pk   | US\$ 63.04  | +Info |
| 418741 | Casting Ring- TaprD 1.75 3/Pk  | US\$ 65.28  | +Info |
| 418742 | Sprue Straight 8 Ga Pk /100    | US\$ 58.56  | +Info |
| 418743 | Sprue Offset (8 Ga) 100 Pk     | US\$ 58.56  | +Info |
| 418744 | Sprue; Straight 13 Ga Pk /100  | US\$ 58.56  | +Info |
| 418745 | Sprue; Reservoir 500 Pk        | US\$ 250.72 | +Info |
| 418746 | Sprue Reserivior Bar Pk /50    | US\$ 48.16  | +Info |
| 418747 | Fluoride Flux                  | US\$ 20.64  | +Info |
| 418749 | Flux; Casting- 3Oz             | US\$ 15.36  | +Info |
| 418751 | Saw Blade; Super- 10/Pk        | US\$ 15.52  | +Info |
| 418752 | Anti-Flux Paste                | US\$ 18.56  | +Info |
| 418758 | Spry;Centrc Occlsl-Wht-10P Haz | US\$ 264.00 | +Info |
| 418760 | Mini Rest Female Only 6/Pk     | US\$ 46.08  | +Info |
| 418761 | Contact Connector(Amber)4 Sets | US\$ 76.48  | +Info |
| 418764 | Artic-U-Loc Intro Kit          | US\$ 43.68  | +Info |
| 418765 | Artic-U-Loc Kit #2 2 Pads      | US\$ 30.24  | +Info |
| 418766 | Artic-U-Loc Kit #6 6 Pads      | US\$ 84.16  | +Info |
| 418768 | Kit; Striker Plate- 144 Plates | US\$ 186.24 | +Info |
| 418769 | Kit; Artic-U-Loc #12-A         | US\$ 46.72  | +Info |
| 418770 | Kit; Super Lab Saw-(3 Blades)  | US\$ 36.80  | +Info |
| 418771 | Super Saw Blade .007- 10/Pk    | US\$ 15.52  | +Info |
| 418772 | Articuloc Magnets- #30C0005    | US\$ 4.00   | +Info |
| 418773 | Articuloc Pole- Pcs Bulk       | US\$ 336.96 | +Info |
| 418774 | Artic-U-Loc Index Pad Black    | US\$ 336.96 | +Info |
| 418775 | Dental; Hoby-L Articulator     | US\$ 329.76 | +Info |
| 418776 | Table; Incisal- Hoby-L         | US\$ 14.88  | +Info |
| 418777 | Pin; Incisal- Hoby-L           | US\$ 24.32  | +Info |
| 418778 | Plate; Plastic Mounting- 10Pk  | US\$ 80.80  | +Info |
| 418779 | Neyclean Gp- Case/6            | US\$ 454.08 | +Info |
| 418780 | Neyclean Sp- Case/6            | US\$ 196.64 | +Info |
| 418781 | Neyclean Ez- Case/6            | US\$ 458.40 | +Info |
| 418782 | Neyclean Gp- Single Can        | US\$ 83.20  | +Info |
| 418784 | Neyclean Ez- Single Can        | US\$ 87.52  | +Info |
| 418785 | Neyclean Gp; Bulk 50Lbs- 5Gal  | US\$ 885.28 | +Info |
| 418786 | Neyclean Sp; Bulk 50Lbs- 5Gal  | US\$ 528.16 | +Info |
| 418787 | Clamp; Tilt Top Model- Survyor | US\$ 97.12  | +Info |
| 418790 | Table; Surveyor                | US\$ 230.08 | +Info |
| 418791 | Ball; Pivot                    | US\$ 35.20  | +Info |
| 418793 | Spindle; Vertical Locknut Styl | US\$ 96.00  | +Info |
| 418794 | Handpiece Holder- Universal    | US\$ 169.92 | +Info |
| 418795 | Holder; Handpiece- Ney         | US\$ 181.92 | +Info |
| 418800 | Carbon Marker Sheath Pk 2      | US\$ 9.00   | +Info |

|        |                                |             |       |
|--------|--------------------------------|-------------|-------|
| 418801 | Screw; Locking- Tilt Top Pivot | US\$ 25.44  | +Info |
| 418802 | Spindle;Vertical-Tighten Screw | US\$ 26.88  | +Info |
| 418804 | Alum Oxide 25 Micron 5Lb       | US\$ 61.12  | +Info |
| 418805 | Alum Oxide 60 Micron 5Lb       | US\$ 41.76  | +Info |
| 418806 | Alum Oxide 60 Micron 25Lb      | US\$ 151.43 | +Info |
| 418807 | Alum Oxide 60 Micron 50Lb      | US\$ 283.84 | +Info |
| 418808 | Stone; Compressed              | US\$ 12.48  | +Info |
| 418809 | Air; Filter / Dryer            | US\$ 333.76 | +Info |
| 418811 | Tube; Tip- 6 1/2               | US\$ 68.96  | +Info |
| 418812 | Tip;Multiple Orifice Cst .064  | US\$ 53.44  | +Info |
| 418813 | Handle; Manual Torch           | US\$ 320.64 | +Info |
| 418814 | Mixer; Standard                | US\$ 82.56  | +Info |
| 418815 | Tip;Multiple Orifice Cst .034  | US\$ 51.20  | +Info |
| 418816 | Valve;Oxygen-Flash Guard Check | US\$ 62.08  | +Info |
| 418817 | Natural Gas Hose Adaptor       | US\$ 12.64  | +Info |
| 418818 | Crucible Conversion Kit        | US\$ 196.96 | +Info |
| 418819 | Tip;Single Orifice Solder 1390 | US\$ 35.20  | +Info |
| 418820 | Tray- Firing- Round- Honeycomb | US\$ 138.72 | +Info |
| 418821 | Air; Filter / Dryer (Pur)      | US\$ 561.44 | +Info |
| 418822 | Casting Ring; Plier            | US\$ 130.24 | +Info |
| 418823 | Tong; Graphite Cruc 23500025   | US\$ 68.80  | +Info |
| 418824 | Torch Handle 23500040          | US\$ 188.32 | +Info |
| 418825 | Torch; Gas 23500041            | US\$ 186.56 | +Info |
| 418827 | Tip; Soldering 23500043        | US\$ 214.88 | +Info |
| 418828 | Tip; Micro Soldering 23500044  | US\$ 186.40 | +Info |
| 418829 | Torch; Erdgas-Oxygen 23500045  | US\$ 186.56 | +Info |
| 418830 | Casting Rings; 3 X 23510058    | US\$ 20.64  | +Info |
| 418831 | Casting Rings; 6 X 23510059    | US\$ 22.24  | +Info |
| 418832 | Casting Rings; 9 X             | US\$ 22.88  | +Info |
| 418833 | Sprue Formers Univsal 23510061 | US\$ 34.56  | +Info |
| 418834 | Crucible; Graphite 23510068    | US\$ 335.20 | +Info |
| 418835 | Crucible; Ceramic 23510069     | US\$ 383.84 | +Info |
| 418836 | Sprue Formers 1 X 23511069     | US\$ 25.60  | +Info |
| 418837 | Sprue Formers; 3 X 23511070    | US\$ 27.36  | +Info |
| 418838 | Sprue Formers; 6 X 23511071    | US\$ 31.52  | +Info |
| 418839 | Sprue Formers; 9 X 23511072    | US\$ 33.92  | +Info |
| 418841 | Deguvest F 100 X 90G 25070290  | US\$ 200.64 | +Info |
| 418842 | Optivest 40X400G               | US\$ 149.28 | +Info |
| 418844 | Deguform 2 X 6Kg               | US\$ 841.28 | +Info |
| 418845 | Isolit 2 X 50 MI (Hazmat)      | US\$ 49.28  | +Info |
| 418847 | Waxit 1000 MI (Hazmat)         | US\$ 107.84 | +Info |
| 418848 | Flux Oxynon 50MI               | US\$ 45.76  | +Info |
| 418849 | Flux-Veriflux Powder 25340001  | US\$ 63.04  | +Info |
| 418850 | Lux-Veriflux Pellets 25340004  | US\$ 63.84  | +Info |
| 418851 | Deguvest Liquid 1350 MI. Blue  | US\$ 47.84  | +Info |
| 418852 | Ring Liners 1X                 | US\$ 38.24  | +Info |
| 418853 | Ring Liners 3X                 | US\$ 39.52  | +Info |
| 418854 | Ring Liners 6X                 | US\$ 41.28  | +Info |
| 418855 | Flux-T;Flubmittel T 25400050   | US\$ 42.88  | +Info |

|        |                                |             |       |
|--------|--------------------------------|-------------|-------|
| 418856 | Spec Liq/Impact Pink 1350MI    | US\$ 55.20  | +Info |
| 418857 | Spec Liq/Impulse Pink 2300MI   | US\$ 73.28  | +Info |
| 418858 | Deguvest Liquid 2300 MI. Blue  | US\$ 66.24  | +Info |
| 418859 | Sandblasting; Material 3 Kg    | US\$ 46.40  | +Info |
| 418860 | Deguvest Impact 100X60G        | US\$ 140.16 | +Info |
| 418861 | Deguvest; Impact 144X90G       | US\$ 233.92 | +Info |
| 418862 | Alloy; Co-Cr 1000G/1Kg         | US\$ 368.96 | +Info |
| 418863 | Memory Card; Ducera            | US\$ 43.84  | +Info |
| 418864 | Lubricant; Krytox- Cergo       | US\$ 144.48 | +Info |
| 418865 | Countrbalnc;Torsion- Cergoprss | US\$ 110.24 | +Info |
| 418866 | O Ring; For Torch (2) 55611000 | US\$ 12.48  | +Info |
| 418867 | Spindle With 1 Arm Ts1         | US\$ 370.56 | +Info |
| 418868 | Bob Weight- Only Ts1           | US\$ 370.56 | +Info |
| 418869 | Extension For Shaft/Cont. Cont | US\$ 370.56 | +Info |
| 418870 | Seal F/Base Plate- Trimmer Gt  | US\$ 370.56 | +Info |
| 418871 | Water Outlet Elbow For Gt2     | US\$ 370.56 | +Info |
| 418872 | M S Attach-Female Rev No Okay* | US\$ 10.80  | +Info |
| 418873 | Dowel Pin; Medium 1000/Pk      | US\$ 344.32 | +Info |
| 418874 | Ney Mini Rest Male             | US\$ 9.22   | +Info |
| 418875 | Wheel- Square Edge Prepolish   | US\$ 52.80  | +Info |
| 418877 | Wheel; Square Edge Sparkle     | US\$ 59.52  | +Info |
| 418878 | Wheel; Knife Edge Sparkle      | US\$ 59.52  | +Info |
| 418879 | Barrel; 7/8X1/4 Pre Polish     | US\$ 52.80  | +Info |
| 418880 | 50 Occlusal Minipoints         | US\$ 60.00  | +Info |
| 418881 | Barrel; 7/8X1/4Sparkle- 50Pk   | US\$ 59.52  | +Info |
| 418882 | Point; 1X1/8 Sparkle Mini      | US\$ 59.52  | +Info |
| 418883 | Wheel; Blue Rubber-Bx 100      | US\$ 27.36  | +Info |
| 418884 | Point; Blue Rubber- Packaged   | US\$ 24.64  | +Info |
| 418885 | Occlusals-Letter K             | US\$ 23.84  | +Info |
| 418886 | Occlusals-Letter L 25/Bag      | US\$ 23.84  | +Info |
| 418888 | Mandrel; Spiral For Barrel *   | US\$ 37.92  | +Info |
| 418889 | Mandrel; Mini Point 3/Pk *     | US\$ 36.96  | +Info |
| 418898 | Vertex; Tray & Spine           | US\$ 112.48 | +Info |
| 418899 | Vertex; Adhesive 20Gm          | US\$ 13.12  | +Info |
| 418900 | Vertex; Adhesive Xthick 28Gm   | US\$ 18.08  | +Info |
| 418901 | 2 Oz Accelerator W/Pump-Hazmat | US\$ 12.00  | +Info |
| 418902 | 8 Oz Accelerator W/Pump-Hazmat | US\$ 26.24  | +Info |
| 418903 | Vertex; Release Block          | US\$ 3.84   | +Info |
| 418904 | Vertex;Rubber Bse Mold Lq 16Mm | US\$ 15.84  | +Info |
| 418905 | Vertex;Rubber Bse Mold Rq 16Mm | US\$ 15.84  | +Info |
| 418906 | Vertex;Rubber Bse Mold Sf 16Mm | US\$ 15.84  | +Info |
| 418907 | Vertex;Rubber Bse Mold Mf 16Mm | US\$ 15.84  | +Info |
| 418908 | Vertex;Rubber Bse Mold Lf 16Mm | US\$ 15.84  | +Info |
| 418909 | Vertex;Rubber Bse Mld Xlf 16Mm | US\$ 15.84  | +Info |
| 418910 | Vertex;Rubbr Frmr Psterior Mld | US\$ 15.84  | +Info |
| 418911 | Vertex;Rubber Bse Mold Lq 20Mm | US\$ 15.84  | +Info |
| 418912 | Vertex;Rubber Bse Mold Rq 20Mm | US\$ 15.84  | +Info |
| 418913 | Rubber Base Mold Sf 20Mm       | US\$ 15.84  | +Info |
| 418914 | Rubber Base Mold Mf 20Mm       | US\$ 15.84  | +Info |

|        |                               |            |       |
|--------|-------------------------------|------------|-------|
| 418915 | Rubber Base Mold Lf 20Mm      | US\$ 15.84 | +Info |
| 418916 | Rubber Base Mold Xlf 20Mm     | US\$ 15.84 | +Info |
| 418917 | Vertex; Round Carbide Bur     | US\$ 50.72 | +Info |
| 418918 | Vertex; Pump Sprayer          | US\$ 4.00  | +Info |
| 418920 | Vertex; Labels- Quadrant      | US\$ 19.20 | +Info |
| 418921 | Vertex; Labels- Full Pressure | US\$ 20.16 | +Info |
| 418922 | Vertex; Pressure Labels-Tray  | US\$ 19.20 | +Info |
| 418929 | Custom Posterior Mold         | US\$ 28.00 | +Info |
| 418938 | Blank Custom Mold Lq 16Mm     | US\$ 30.88 | +Info |
| 418939 | Blank Custom Mold Rq 16Mm     | US\$ 30.88 | +Info |
| 418940 | Blank Custom Mold Sf 16Mm     | US\$ 30.88 | +Info |
| 418941 | Blank Custom Mold Mf 16Mm     | US\$ 30.88 | +Info |
| 418942 | Blank Custom Mold Lf 16Mm     | US\$ 30.88 | +Info |
| 418943 | Blank Custom Mold Xlf 16Mm    | US\$ 30.88 | +Info |
| 418944 | Blank Custom Posterior Mold   | US\$ 30.88 | +Info |
| 418945 | Blank Custom Mold Lqd 20Mm    | US\$ 30.88 | +Info |
| 418946 | Blank Custom Mold Rqd 20Mm    | US\$ 30.88 | +Info |
| 418947 | Blank Custom Mold Sfd 20Mm    | US\$ 30.88 | +Info |
| 418948 | Blank Custom Mold Mfd 20Mm    | US\$ 30.88 | +Info |
| 418949 | Blank Custom Mold Lfd 20Mm    | US\$ 30.88 | +Info |
| 418950 | Blank Custom Mold Xlfd 20Mm   | US\$ 30.88 | +Info |

### General Parts & Replacenents

## General Replacement Parts



### General Replacement Parts - AMANN GIRRBACH

General Replacement Parts - AMANN GIRRBACH

| Code   | Name                          | Price      | +     |
|--------|-------------------------------|------------|-------|
| 124257 | AG HOLDER f/GLASS CERAMIC X10 | US\$ 34.45 | +Info |

### General Replacement Parts - VANIMAN

General Replacement Parts - VANIMAN

| Code   | Name                        | Price      | +     |
|--------|-----------------------------|------------|-------|
| 474940 | Walnut Shell 50 micron 15lb | US\$ 38.16 | +Info |

## PARTS FOR VANIMAN

### Odor Filters

Odor Filters

| Code   | Name                 | Price      | +     |
|--------|----------------------|------------|-------|
| 420133 | Charcoal/Odor Filter | US\$ 50.40 | +Info |



### Other Models

#### Other Models

| Code   | Name                                | Price      | +     |
|--------|-------------------------------------|------------|-------|
| 420130 | IMES Mill AutoSync Connection       | US\$ 80.67 | +Info |
| 420131 | Digital Dental Mill AutoSync Connec | US\$ 80.67 | +Info |
| 420132 | Filter Bag for Dental Drawer S      | US\$ 17.99 | +Info |
| 420137 | Ceramic Tip (2 per Pk )             | US\$ 40.73 | +Info |
| 420138 | Standard Steel Tip                  | US\$ 8.45  | +Info |
| 420139 | Static Cling Protector for SandStor | US\$ 37.22 | +Info |
| 420140 | Static Cling Protector for SandStor | US\$ 37.22 | +Info |
| 420144 | Walnut Shell (100 micron)           | US\$ 32.94 | +Info |
| 420145 | Small PKT                           | US\$ 32.96 | +Info |
| 420146 | Extra Spatula Assy. With tip combin | US\$ 71.50 | +Info |

### Parts for Biosonic - COLTENE



| Code   | Name                                | Price      | +     |
|--------|-------------------------------------|------------|-------|
| 426809 | BioSonic Replacement Drain Filters  | US\$ 14.90 | +Info |
| 426832 | BioSonic Replacement Drain Hose (5/ | US\$ 32.38 | +Info |

### Replacement Parts - ZHERMACK



#### ADAPTER

| Code | Name | Price | + |
|------|------|-------|---|
|------|------|-------|---|

|        |  |            |                       |
|--------|--|------------|-----------------------|
| 118673 | ZHERMACK DoubleMix 1 kg Adapter (Base) - Z#XR0240040     | US\$ 85.15 | <a href="#">+Info</a> |
| 118674 | ZHERMACK DoubleMix 1 kg Adapter (Catalyst) - Z#XR0240050 | US\$ 85.15 | <a href="#">+Info</a> |

### General Parts & Replacements

## HANDLER General Replacement parts



### #60U Replacement parts



Equipment and Technology Solutions

| Code   | Name  | Price         | +                     |
|--------|---|---------------|-----------------------|
| 474993 | HANDLER - Motor-Mounting Bolts,Each - # P60U-11 ( Replacement Parts )           | US\$ 16.74    | <a href="#">+Info</a> |
| 475005 | HANDLER - Bearings For 60U Motor - # P60U-22 ( Replacement Parts )              | US\$ 51.78    | <a href="#">+Info</a> |
| 475004 | HANDLER - Wing Screws (3) - # P60U-21 ( Replacement Parts )                     | US\$ 7.61     | <a href="#">+Info</a> |
| 475003 | HANDLER - Tray Lower Cabinet For 60U - # P60U-20 ( Replacement Parts )          | US\$ 63.95    | <a href="#">+Info</a> |
| 475002 | HANDLER - Inlet Flange - # P60U-19 ( Replacement Parts )                        | US\$ 30.46    | <a href="#">+Info</a> |
| 475001 | HANDLER - Plug Only - # P60U-18 ( Replacement Parts )                           | US\$ 9.14     | <a href="#">+Info</a> |
| 475000 | HANDLER - Line Cord With Plug - # P60U-17 ( Replacement Parts )                 | US\$ 24.35    | <a href="#">+Info</a> |
| 474999 | HANDLER - Switch On/Off - # P60U-16 ( Replacement Parts )                       | US\$ 21.32    | <a href="#">+Info</a> |
| 474998 | HANDLER - Line Cord Switch On/Off - # P60U-15 ( Replacement Parts )             | US\$ 36.54    | <a href="#">+Info</a> |
| 474997 | HANDLER - Felt 1" X 3/16" Thk Psa - Per Foot - # P60U-14A ( Replacement Parts ) | US\$ 4.58     | <a href="#">+Info</a> |
| 474996 | HANDLER - Felt 1/8" X 9/16" Psa Per Foot - # P60U-14 ( Replacement Parts )      | US\$ 4.58     | <a href="#">+Info</a> |
| 474995 | HANDLER - Arbor For Suction Wheel - # P60U-13 ( Replacement Parts )             | US\$ 57.86    | <a href="#">+Info</a> |
| 474994 | HANDLER - Motor-Mounts-Rubber (Set Of 4) - # P60U-12 ( Replacement Parts )      | US\$ 25.88    | <a href="#">+Info</a> |
| 474981 | HANDLER - Motor Suction 1/2 Hp For 60U - # P60U-01 ( Replacement Parts )        | US\$ 539.03   | <a href="#">+Info</a> |
| 474992 | HANDLER - Thumb Screw For Hold-Down B - # P60U-10 ( Replacement Parts )         | US\$ 12.19    | <a href="#">+Info</a> |
| 474991 | HANDLER - Bag Hold-Down Bar One Each - # P60U-09 ( Replacement Parts )          | US\$ 25.88    | <a href="#">+Info</a> |
| 474990 | HANDLER - Shaker Handle Only - # P60U-08 ( Replacement Parts )                  | US\$ 44.15    | <a href="#">+Info</a> |
| 474989 | HANDLER - Dc Shaker Bar Bushing - # P60U-07A ( Replacement Parts )              | US\$ 25.88    | <a href="#">+Info</a> |
| 474988 | HANDLER - Shaker Assembly W/Handle - # P60U-07 ( Replacement Parts )            | US\$ 92.88    | <a href="#">+Info</a> |
| 474987 | HANDLER - Door Latch - # P60U-06A ( Replacement Parts )                         | US\$ 19.80    | <a href="#">+Info</a> |
| 474986 | HANDLER - Door Latch For 60U Dc - # P60U-06 ( Replacement Parts )               | US\$ 21.32    | <a href="#">+Info</a> |
| 474985 | HANDLER - Door For 60U W/O Latches - # P60U-05 ( Replacement Parts )            | US\$ 242.11   | <a href="#">+Info</a> |
| 474984 | HANDLER - Cabinet Only W/O Door - # P60U-04 ( Replacement Parts )               | US\$ 1,434.37 | <a href="#">+Info</a> |
| 474983 | HANDLER - Suction Housing - # P60U-03 ( Replacement Parts )                     | US\$ 111.16   | <a href="#">+Info</a> |
| 474982 | HANDLER - Wheel Suction 60U - # P60U-02 ( Replacement Parts )                   | US\$ 109.63   | <a href="#">+Info</a> |

### Replacement Parts for Lathes HANDLER

| Code   | Name  | Price      | +                     |
|--------|---|------------|-----------------------|
| 464550 | #P16-11 Handler Chuck Changer Clutch Lining #P16-11 | US\$ 22.59 | <a href="#">+Info</a> |

### General Parts & Replacements

## Model Trimmer Replacement Parts



### BUFFALO Model trimmer Replacement Parts

Model trimmer Replacement Parts - BUFFALO



| Code   | Name   | Price       | +     |
|--------|--|-------------|-------|
| 425209 | BUFFALO User Installed Water Control Solenoid for Model Trimmer, 220V - #61905     | US\$ 124.25 | +Info |
| 425210 | BUFFALO Factory Installed Water Control Solenoid for Model Trimmer, 220V - #61906  | US\$ 154.78 | +Info |
| 425203 | BUFFALO DryTrim Grinding Belts Trimmer, Extra Coarse (New Sharper 40 Grit ), Pa... | US\$ 34.66  | +Info |
| 425206 | BUFFALO DryTrim Grinding Belts Trimmer, Coarse (60 Grit ), Package of 3 Belts -... | US\$ 34.66  | +Info |
| 425211 | BUFFALO Factory Installed Water Control Solenoid for Model Trimmer, 110V - #61901  | US\$ 154.78 | +Info |
| 424565 | BUFFALO User Installed Water Control Solenoid for Model Trimmer, 110V - #61900     | US\$ 120.63 | +Info |

### WHIP MIX Model Trimmer replacement parts

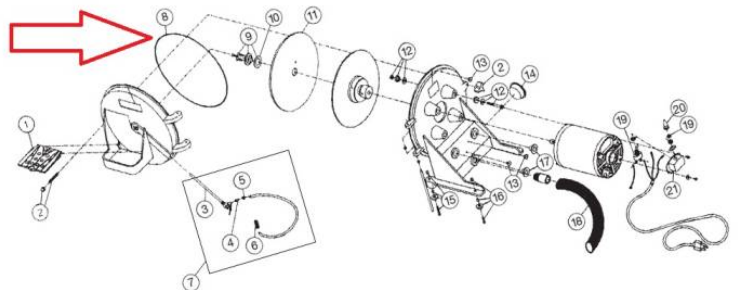

| Code   | Name  | Price       | +     |
|--------|---|-------------|-------|
| 120218 | WHIP MIX #36039 Door Gasket 46 In - #09666                | US\$ 28.30  | +Info |
| 120243 | WHIP MIX #30104 Door Gasket 10in Trimmer - #21571         | US\$ 26.87  | +Info |
| 120242 | WHIP MIX #30122 Door Gasket 12in Trimmer - #21156         | US\$ 29.56  | +Info |
| 120226 | WHIP MIX #36114 Switch 3/4hp - #09646                     | US\$ 57.73  | +Info |
| 120224 | WHIP MIX #36046 Work Table F/ 3/4 Hp Mt - #09670          | US\$ 80.04  | +Info |
| 120222 | WHIP MIX #36034 Drain Hose 40 In - #09658                 | US\$ 36.93  | +Info |
| 120221 | WHIP MIX #36117/#36128 Solenoid Valve Assy 3/4hp - #09647 | US\$ 224.10 | +Info |
| 120220 | WHIP MIX #36041 Spray Tube Assy F/3/4 Hp Mt - #09667      | US\$ 219.08 | +Info |
| 120219 | WHIP MIX #36125 Model Trimmer Drain Hose 1.5in - #21119   | US\$ 25.97  | +Info |
| 120244 | WHIP MIX #30483 Work Table Assembly 12in - #21717         | US\$ 59.76  | +Info |
| 120241 | WHIP MIX #30217 3 Facing Pads F/vertisquare - #21261      | US\$ 31.44  | +Info |
| 120240 | WHIP MIX #34017 Spray Tube Assembly - #21148              | US\$ 80.10  | +Info |
| 120239 | WHIP MIX #30704 Water Spray Attach Holster - #31887       | US\$ 29.19  | +Info |
| 120238 | WHIP MIX #30045 Settingga 70mm - #22446                   | US\$ 81.47  | +Info |
| 120227 | WHIP MIX #35015 Ortho Table Assy F/convert - #12777       | US\$ 483.67 | +Info |
| 120230 | WHIP MIX #35175 Water Spray Attachment - #12939           | US\$ 104.04 | +Info |

|        |  |             |                       |
|--------|--|-------------|-----------------------|
| 120228 | WHIP MIX #34008 Electric Water Valve 110v - #12823 | US\$ 261.33 | <a href="#">+Info</a> |
| 120237 | WHIP MIX #34076 Attach Button Assembly - #22020    | US\$ 42.88  | <a href="#">+Info</a> |
| 120235 | WHIP MIX #34033 Vertisquare Assembly - #21695      | US\$ 157.95 | <a href="#">+Info</a> |
| 120234 | WHIP MIX #30130 Trimmer Drain Hose 2in - #21121    | US\$ 17.57  | <a href="#">+Info</a> |
| 120472 | WHIP MIX #10367 Fuse 12 Amp pk 2 - #96016          | US\$ 23.80  | <a href="#">+Info</a> |

### General Parts & Replacenents

## Reliable Replacement Parts



### Reliable Replacement Parts - RELIABLE

Reliable Replacement Parts - RELIABLE

| Code   | Name                 | Price      | +                     |
|--------|----------------------|------------|-----------------------|
| 474941 | I500B Pressure Gauge | US\$ 79.24 | <a href="#">+Info</a> |

### General Parts & Replacenents

## Renfert Replacement Parts



### RENFERT - REPLACEMENT ITEMS



| Code   | Name   | Price       | +                     |
|--------|--|-------------|-----------------------|
| 417566 | RENFERT - Brush insert- RED sable Kolinsky size #8 P2 - #14700800 (poretta is n... | US\$ 111.32 | <a href="#">+Info</a> |
| 417565 | RENFERT - Brush insert- Takanishi- size #3 P2 - #14700310                          | US\$ 46.37  | <a href="#">+Info</a> |
| 417564 | RENFERT - Brush insert- RED sable Kolinsky size #3 P2 - #14700300                  | US\$ 56.40  | <a href="#">+Info</a> |
| 417563 | RENFERT - Brush insert- Takanishi- size #2 P2 - #14700210                          | US\$ 42.90  | <a href="#">+Info</a> |
| 417562 | RENFERT - Brush insert- RED sable Kolinsky size #2 P2 - replacement part Poret...  | US\$ 20.22  | <a href="#">+Info</a> |
| 417561 | RENFERT - Brush insert- RED sable Kolinsky size #1 P2 Replacement part Poretta ... | US\$ 23.41  | <a href="#">+Info</a> |
| 417406 | RENFERT - Draining system 2940-0000 EACH - #33352                                  | US\$ 130.91 | <a href="#">+Info</a> |
| 417405 | RENFERT - Straight airhose fitting EACH - #33064                                   | US\$ 15.96  | <a href="#">+Info</a> |
| 417404 | RENFERT - Wall mounting hardware for twister EACH - #21284                         | US\$ 5.99   | <a href="#">+Info</a> |
| 417402 | RENFERT - Mixing chamber BASIC 25-70 m all blasters- EACH - #21110                 | US\$ 167.37 | <a href="#">+Info</a> |
| 417401 | RENFERT - Quick connect american standar EACH - #21068                             | US\$ 15.61  | <a href="#">+Info</a> |
| 417400 | RENFERT - Electric foot switch/vario jet EACH - #21026                             | US\$ 180.68 | <a href="#">+Info</a> |
| 120965 | RENFERT - Fuse Set Vario-jet- 120 V - #929610003                                   | US\$ 8.99   | <a href="#">+Info</a> |
| 120964 | RENFERT - Hardware Vario Basic - #929600006  | US\$ 28.74  | <a href="#">+Info</a> |
| 120963 | RENFERT - Mixing Chamber Compl. - #929600004                                       | US\$ 237.74 | <a href="#">+Info</a> |
| 120962 | RENFERT - Four-way Junction Compl. 2960 - #929600002                               | US\$ 307.78 | <a href="#">+Info</a> |
| 120957 | RENFERT - Hinge Complete - #929540003  | US\$ 71.30  | <a href="#">+Info</a> |
| 120956 | RENFERT - Air Blast Nozzle Tip- Complete (with Hose) - #929540001                  | US\$ 61.09  | <a href="#">+Info</a> |
| 120955 | RENFERT - Hardware Basic - #929470002  | US\$ 56.40  | <a href="#">+Info</a> |
| 120954 | RENFERT - Edge Protection Basic - #929470001                                       | US\$ 28.74  | <a href="#">+Info</a> |

|        |   |             |       |
|--------|---|-------------|-------|
| 120953 | RENFERT - Pressure Regulator Basic Master - #929460001          | US\$ 211.11 | +Info |
| 120950 | RENFERT - Container Complete - #929240013                       | US\$ 616.88 | +Info |
| 120948 | RENFERT - Rotating Socketend Dn 36 - #929230011                 | US\$ 86.58  | +Info |
| 120947 | RENFERT - Socketend Nozzle Size Dn36 - #929230010               | US\$ 59.42  | +Info |
| 120946 | RENFERT - Guide Roll - #929230009                               | US\$ 29.56  | +Info |
| 120945 | RENFERT - Wheel Set - #929230008                                | US\$ 32.59  | +Info |
| 120944 | RENFERT - Retainer Ring - #929230007                            | US\$ 52.32  | +Info |
| 120941 | RENFERT - Set Of Fuses 2921/120 V - #929210004                  | US\$ 12.77  | +Info |
| 120940 | RENFERT - Set Of Joints For Silent - #929210002                 | US\$ 28.74  | +Info |
| 120939 | RENFERT - Hardware Silent - #929210001                          | US\$ 28.74  | +Info |
| 120936 | RENFERT - It Handpiece Basic Mobil 90-500 Um - #929140500       | US\$ 46.96  | +Info |
| 120935 | RENFERT - It Handpiece Basic Mobill 25-50 Um - #929140050       | US\$ 44.20  | +Info |
| 120931 | RENFERT - Lamp Ballast For Upgrade Kit 90-110V - #929003120     | US\$ 296.70 | +Info |
| 120930 | RENFERT - Air Release Valve- Lid Quattro Is - #929000010        | US\$ 19.72  | +Info |
| 120929 | RENFERT - Ventilating Flap Basic Quattro - #929000009           | US\$ 13.19  | +Info |
| 120928 | RENFERT - Wood Support For Dustex - #926260004                  | US\$ 35.91  | +Info |
| 120927 | RENFERT - Edge Protection For Dustex - #926260003               | US\$ 32.99  | +Info |
| 120925 | RENFERT - Plastic Eye-cup For Micro-scope 2pk - #922000020      | US\$ 3.20   | +Info |
| 120924 | RENFERT - Ocular Holder- Adjustable - #922000003                | US\$ 97.93  | +Info |
| 120921 | RENFERT - Hardware For Mt3/mt3 Pro - #918080001                 | US\$ 27.66  | +Info |
| 120919 | RENFERT - Plastic Base For Tropicolino Tray - #910680001        | US\$ 38.30  | +Info |
| 120917 | RENFERT - Hollow Needle Nr. 4 1.7mm 968-1400 - #909681404       | US\$ 27.60  | +Info |
| 120916 | RENFERT - Hollow Needle Nr.3 1.1mm 968-1400 - #909681403        | US\$ 27.60  | +Info |
| 120915 | RENFERT - Hollow Needle Nr.2 0.8mm 968-1400 - #909681402        | US\$ 29.28  | +Info |
| 120914 | RENFERT - Hollow Needle Nr.1 0.6mm 968-1400 - #909681401        | US\$ 26.56  | +Info |
| 120912 | RENFERT - Nozzle No. 3 For Fehr Torch 968-0200 - #909680203     | US\$ 78.56  | +Info |
| 120911 | RENFERT - Nozzle No. 2 For Fehr Torch 968-0200 - #909680202     | US\$ 77.70  | +Info |
| 120910 | RENFERT - Nozzle No. 1 For Fehr Torch 968-0200 - #909680201     | US\$ 77.81  | +Info |
| 120909 | RENFERT - Large O-ring For Torch Insert - #909680002            | US\$ 14.66  | +Info |
| 120908 | RENFERT - Small O-ring For Torch Insert - #909680001            | US\$ 9.76   | +Info |
| 120905 | RENFERT - Lower Front Cover For Silent - #900234222             | US\$ 75.70  | +Info |
| 120904 | RENFERT - Outlet Hose Mt Plus - #900150449                      | US\$ 40.43  | +Info |
| 120900 | RENFERT - Transformer Waxelectric 2140/39 - #900038544          | US\$ 94.04  | +Info |
| 120899 | RENFERT - Hose Feed Fixation Quattro/quattro Is - #900036683    | US\$ 34.92  | +Info |
| 120898 | RENFERT - Cover For Lamp - #900036659                           | US\$ 15.97  | +Info |
| 120897 | RENFERT - Adjusting Screw Mtplus - #900036628                   | US\$ 34.05  | +Info |
| 120896 | RENFERT - Tools For Mt3/mt3 Pro - #900036614                    | US\$ 20.96  | +Info |
| 120895 | RENFERT - Rear Pressure Regulator Basic Quattro Is - #900036600 | US\$ 170.23 | +Info |
| 120893 | RENFERT - Inlet Filter Master/quattro - #900036598              | US\$ 149.31 | +Info |
| 120892 | RENFERT - Door Joint Mt3/mt3 Pro - #900036511                   | US\$ 20.22  | +Info |
| 120890 | RENFERT - Mixing Chamber Is 70-250m - #900036422                | US\$ 172.13 | +Info |
| 120889 | RENFERT - Mixing Chamber Is 25-70m - #900036421                 | US\$ 172.13 | +Info |
| 120888 | RENFERT - Check Valve Is - #900036415                           | US\$ 36.18  | +Info |
| 120887 | RENFERT - Inside Pressure Regulator Is - #900036414             | US\$ 118.54 | +Info |
| 120886 | RENFERT - Inside Pressure Regulator Mas/quattro - #900036413    | US\$ 118.54 | +Info |
| 120885 | RENFERT - Cap On/off Switch Mt3 - #900036412                    | US\$ 15.96  | +Info |
| 120884 | RENFERT - Valve Unit Is - #900036409                            | US\$ 330.93 | +Info |
| 120883 | RENFERT - Spray Pipe Mt3/mt3 Pro - #900036405                   | US\$ 31.92  | +Info |
| 120881 | RENFERT - Mixing Chamber 70-250m - #900036387                   | US\$ 172.13 | +Info |



|        |  |             |       |
|--------|--|-------------|-------|
| 120880 | RENFERT - Mixing Chamber 25-70m - #900036386                 | US\$ 172.13 | +Info |
| 120879 | RENFERT - Dosing Nozzle 70-250um Removable - #900036354      | US\$ 24.48  | +Info |
| 120878 | RENFERT - Dosing Nozzle 25/70um Removable - #900036353       | US\$ 24.48  | +Info |
| 120877 | RENFERT - Ring For Hand Sleeves - #900036339                 | US\$ 23.41  | +Info |
| 120874 | RENFERT - Uncoated Glass Screen Classic - #900036327         | US\$ 92.77  | +Info |
| 120873 | RENFERT - Uncoated Glass Master/quattro - #900036311         | US\$ 122.67 | +Info |
| 120872 | RENFERT - Flange Mt3/mt3 Pro Complete - #900036296           | US\$ 144.31 | +Info |
| 120871 | RENFERT - Bracket Mt3 - #900036293                           | US\$ 15.97  | +Info |
| 120870 | RENFERT - Mt3/mt3 Pro Trimmer Table - #900036292             | US\$ 38.91  | +Info |
| 120869 | RENFERT - Door Locker Mt3/mt3 Pro - #900036267               | US\$ 34.92  | +Info |
| 120868 | RENFERT - O-ring Set New Pillos - #900036176                 | US\$ 35.12  | +Info |
| 120867 | RENFERT - Power Supply Waxlectric 2150-2157xxxx - #900036138 | US\$ 39.17  | +Info |
| 120866 | RENFERT - Thermocouple For Magma - #900036006                | US\$ 354.01 | +Info |
| 120865 | RENFERT - Grip Set Magma - #900036000                        | US\$ 24.45  | +Info |
| 120864 | RENFERT - Power Cord Waxlectric Us - #900035976              | US\$ 14.97  | +Info |
| 120863 | RENFERT - Chimney For Magma Oven - #900035962                | US\$ 151.26 | +Info |
| 120862 | RENFERT - Cork-grip For New Waxer - #900035948               | US\$ 13.84  | +Info |
| 120861 | RENFERT - Set Of Pressure Plates - #900035923                | US\$ 44.69  | +Info |
| 120860 | RENFERT - Porcelain Slab Magma - #900035861                  | US\$ 64.66  | +Info |
| 120859 | RENFERT - Front Label Hotty 1461 - #900035821                | US\$ 30.42  | +Info |
| 120855 | RENFERT - Protective Cap On/off Switch Mt Plus - #900035788  | US\$ 19.15  | +Info |
| 120854 | RENFERT - Front Label Hotty 1460 - #900035773                | US\$ 31.92  | +Info |
| 120851 | RENFERT - Dust Tray For Top-spin - #900035730                | US\$ 28.74  | +Info |
| 120850 | RENFERT - Mtplus Trimmer Table Complete - #900035717         | US\$ 217.77 | +Info |
| 120849 | RENFERT - Spray Tube Mtplus Compl. - #900035716              | US\$ 136.06 | +Info |
| 120848 | RENFERT - Gasket Set Mt Plus/door & Drive Shaft - #900035711 | US\$ 24.48  | +Info |
| 120847 | RENFERT - Mtplus Hinges Complete - #900035708                | US\$ 60.66  | +Info |
| 120846 | RENFERT - Exhaust Air Filter - #9000-35700                   | US\$ 53.20  | +Info |
| 120845 | RENFERT - Top- Spin Fuse Set 110 V - #900035678              | US\$ 9.58   | +Info |
| 120844 | RENFERT - Rubber Insert 2955 - #900035677                    | US\$ 22.38  | +Info |
| 120843 | RENFERT - Operating Lever Set Vibrax - #900035635            | US\$ 23.94  | +Info |
| 120842 | RENFERT - Rubber Mat For Vibrax - #900035626                 | US\$ 80.86  | +Info |
| 120841 | RENFERT - Screw For Trimmer Disc Mt1 - #900035575            | US\$ 13.07  | +Info |
| 120840 | RENFERT - Protective Mat- Basket - #900035552                | US\$ 14.90  | +Info |
| 120839 | RENFERT - Light Complete For Vario Jet - #900035548          | US\$ 131.94 | +Info |
| 120838 | RENFERT - Collet Chuck & Set Screw Complete - #900035468     | US\$ 65.97  | +Info |
| 120837 | RENFERT - Pressure Regulator Varoi Jet - #900035453          | US\$ 125.75 | +Info |
| 120836 | RENFERT - Protective Gloves - #900035451                     | US\$ 34.05  | +Info |
| 120835 | RENFERT - Extraction Filter Cpl - #9000-35448                | US\$ 24.48  | +Info |
| 120834 | RENFERT - Operation Magnet - #900035447                      | US\$ 13.84  | +Info |
| 120833 | RENFERT - Shaft Cpl - #900035446                             | US\$ 80.86  | +Info |
| 120832 | RENFERT - Motor For Vario Jet Basket - #900035443            | US\$ 383.84 | +Info |
| 120831 | RENFERT - Grate For Vario Jet - #900035436                   | US\$ 118.54 | +Info |
| 120830 | RENFERT - Mixing Chamber 2961 - #900035433                   | US\$ 218.72 | +Info |
| 120829 | RENFERT - Blasting Nozzle Tip Compl. 2960 - #900035431       | US\$ 220.62 | +Info |
| 120828 | RENFERT - Pressure Regulator Compl. 2960 - #900035357        | US\$ 142.24 | +Info |
| 120824 | RENFERT - Set Of Isolations Vario E - #900035256             | US\$ 39.78  | +Info |
| 120823 | RENFERT - Lid Complete Vario E - #900035252                  | US\$ 83.05  | +Info |
| 120822 | RENFERT - Screw For Mt Plus Disc - #900035237                | US\$ 6.99   | +Info |



|        |  |             |       |
|--------|--|-------------|-------|
| 120821 | RENFERT - Drawer Seal Locking Clips - #900035147                   | US\$ 30.86  | +Info |
| 120820 | RENFERT - Power Supply Led Microscope - #900034769                 | US\$ 92.77  | +Info |
| 120819 | RENFERT - Light Cover Led Microscope - #900034765                  | US\$ 19.15  | +Info |
| 120813 | RENFERT - Rplmt Ballast Classic/vario/dust w/light - #900034625    | US\$ 312.87 | +Info |
| 120812 | RENFERT - Perforated Plate Dustex Master Plus - #900034614         | US\$ 26.62  | +Info |
| 120811 | RENFERT - Isolation Set From B 1440xxx - #900034592                | US\$ 22.85  | +Info |
| 120810 | RENFERT - Retainer For Blasting Nozzle Tip - #900034590            | US\$ 77.68  | +Info |
| 120808 | RENFERT - Front Label Hotty 1457 - #900034580                      | US\$ 23.67  | +Info |
| 120807 | RENFERT - Lid Hotty / BLUE Print - #900034579                      | US\$ 19.90  | +Info |
| 120806 | RENFERT - Front Label Waxprofi 1440 - #900034575                   | US\$ 24.48  | +Info |
| 120805 | RENFERT - Isolation Set Waxprofi 1440 - #900034573                 | US\$ 14.50  | +Info |
| 120804 | RENFERT - Isolation Set Hotty 1457+1460 - #900034566               | US\$ 15.62  | +Info |
| 120803 | RENFERT - Rubber Bases Vario/profi - #900034564                    | US\$ 10.64  | +Info |
| 120802 | RENFERT - Front Label Vario E 1452 - #900034549                    | US\$ 23.41  | +Info |
| 120801 | RENFERT - Lid For Vario E And Profi - #900034543                   | US\$ 14.97  | +Info |
| 120799 | RENFERT - Protective Gloves Vario Basic - #900034523               | US\$ 19.15  | +Info |
| 120798 | RENFERT - Grate For Vario Basic - #900034516                       | US\$ 148.43 | +Info |
| 120797 | RENFERT - Light Cover Soft Touch Ballast - #900034338              | US\$ 12.77  | +Info |
| 120796 | RENFERT - Catalyser Cartridge - #900034333                         | US\$ 504.58 | +Info |
| 120795 | RENFERT - Y-junction For Silent - #900034314                       | US\$ 51.07  | +Info |
| 120791 | RENFERT - Fine Filter Set Silent TS/TS2 #900034236                 | US\$ 217.77 | +Info |
| 120790 | RENFERT - Electronics Fan Air Filter Complete - #9000-34224        | US\$ 11.97  | +Info |
| 120789 | RENFERT - Dust Retainer - #9000-34221                              | US\$ 108.24 | +Info |
| 120788 | RENFERT - Exhaust Filter Set - #9000-34220                         | US\$ 20.22  | +Info |
| 120787 | RENFERT - Set Of Fuses 1821 / 120 V - #900034187                   | US\$ 8.99   | +Info |
| 120786 | RENFERT - Set Of Fuses 1820 / 120 V - #900034186                   | US\$ 6.38   | +Info |
| 120784 | RENFERT - Compressed Air Filter Complete 2960 - #900034109         | US\$ 114.42 | +Info |
| 120783 | RENFERT - Ventilating Flap 2946 - #900034104                       | US\$ 7.46   | +Info |
| 120782 | RENFERT - Grate For Master 2946 - #900034101                       | US\$ 24.48  | +Info |
| 120779 | RENFERT - Grate For Quattro & Quattro Is - #900034013              | US\$ 151.21 | +Info |
| 120778 | RENFERT - Grate For Basic Classic - #900034011                     | US\$ 55.33  | +Info |
| 120777 | RENFERT - Light Switch Cap For Ballast Dustex/classic - #900034010 | US\$ 18.10  | +Info |
| 120776 | RENFERT - Light Cover For 2945/2960/2626 - #900034005              | US\$ 12.77  | +Info |
| 120775 | RENFERT - Flange Mt Plus (old Version) - #900033454                | US\$ 232.99 | +Info |
| 120774 | RENFERT - Flange Mtplus - #9000-33452                              | US\$ 247.25 | +Info |
| 120773 | RENFERT - Set Of O-rings For Flange - #900033450                   | US\$ 21.28  | +Info |
| 120772 | RENFERT - Millo Pro Work Table - #900033430                        | US\$ 90.71  | +Info |
| 120770 | RENFERT - Clip Socket Millos - #900033385                          | US\$ 80.86  | +Info |
| 120769 | RENFERT - Ball-set For Pillo 5022 - #900033234                     | US\$ 4.26   | +Info |
| 120768 | RENFERT - Door Latch Mt Plus Complete - #900033150                 | US\$ 35.12  | +Info |
| 120765 | RENFERT - Hinge Clips w/screws - #900033005                        | US\$ 21.28  | +Info |
| 120763 | RENFERT - Edge Protection For Glass Pane - #9000-32729             | US\$ 18.10  | +Info |
| 120761 | RENFERT - Halogen Light/poretta Transformer - #900032328           | US\$ 175.93 | +Info |
| 120760 | RENFERT - Print Fuse T 4a - #900030785                             | US\$ 37.91  | +Info |
| 120751 | RENFERT - Led Lamp Complete Clas/ Mas/quattro - #900021428         | US\$ 314.77 | +Info |
| 120749 | RENFERT - Inlet Filter - #900021389                                | US\$ 30.86  | +Info |
| 120746 | RENFERT - Magnifier For Dustex - #900021383                        | US\$ 164.52 | +Info |
| 120745 | RENFERT - Adjusting Ring - #900021366                              | US\$ 40.43  | +Info |
| 120744 | RENFERT - Ballsocket For Trimmer Table - #900021357                | US\$ 23.41  | +Info |

|        |  |             |       |
|--------|--|-------------|-------|
| 120742 | RENFERT - Connecting Hose Complete Power Pillo - #900021174  | US\$ 152.55 | +Info |
| 120741 | RENFERT - Connecting Hose For Pillo Complete - #900021169    | US\$ 90.71  | +Info |
| 120740 | RENFERT - Air Hose For Power Pillo - #900021135              | US\$ 31.06  | +Info |
| 120739 | RENFERT - Pressure Regulator Classic/prof - #900021048       | US\$ 160.72 | +Info |
| 120738 | RENFERT - Admission Hose Compl. Trimmer - #900020976         | US\$ 42.56  | +Info |
| 120737 | RENFERT - Pneumatic Foot Switch - #900020921                 | US\$ 243.44 | +Info |
| 120735 | RENFERT - Cleaning Breaker w/lid - #65000500                 | US\$ 28.98  | +Info |
| 120733 | RENFERT - Rivet Chisel For Power-pillo - #50220500           | US\$ 103.51 | +Info |
| 120716 | RENFERT - Soldering Tweezers - #28230000                     | US\$ 23.07  | +Info |
| 120714 | RENFERT - Dust Extraction Kit - #26260500                    | US\$ 205.41 | +Info |
| 120713 | RENFERT - Set Of Armrests - #26260400                        | US\$ 136.06 | +Info |
| 120709 | RENFERT - Microscope Swivel Arm- Standard - #22000401        | US\$ 596.91 | +Info |
| 120708 | RENFERT - Denture Tip - #21410112                            | US\$ 75.57  | +Info |
| 120680 | RENFERT - Laboratory Work Containers - #13001000             | US\$ 11.42  | +Info |
| 120678 | RENFERT - Pointed Pliers - #12210200                         | US\$ 53.64  | +Info |
| 120677 | RENFERT - Sakura Marking Pencil - #11990000                  | US\$ 19.99  | +Info |
| 120675 | RENFERT - Agate Mixing Spatula - #11570000                   | US\$ 45.76  | +Info |
| 120652 | RENFERT - Geo Fix Positioning Wax - #5050110                 | US\$ 13.01  | +Info |
| 120647 | RENFERT - Pro-fix Precision Pin - #3671000                   | US\$ 23.94  | +Info |
| 120638 | RENFERT - Drain Hose Mt 1 - #150204                          | US\$ 39.92  | +Info |
| 120635 | RENFERT - Power Supply Hotty 110vol For Hollow Plug - #33341 | US\$ 85.54  | +Info |
| 120634 | RENFERT - Set Screw For Power Pillo - #33330                 | US\$ 11.42  | +Info |
| 120633 | RENFERT - Power Supply Vario E 110vol - #33327               | US\$ 222.39 | +Info |
| 120632 | RENFERT - Cap On/off Switch Mt 1 - #33253                    | US\$ 8.32   | +Info |
| 120631 | RENFERT - Check Valve For2955 Tank - #33068                  | US\$ 59.58  | +Info |
| 120629 | RENFERT - O-ring For Tank Lid- All Blasters - #900033035     | US\$ 5.33   | +Info |
| 120628 | RENFERT - Transformer For Hotty Led Solid Plug - #32985      | US\$ 174.02 | +Info |
| 120627 | RENFERT - Handle O-ring Old Waxlectric - #32946              | US\$ 0.94   | +Info |
| 120626 | RENFERT - Cap On/off Switch Mt 1 - #32281                    | US\$ 6.08   | +Info |
| 120625 | RENFERT - Spray Tube Mt1 - #31872                            | US\$ 135.53 | +Info |
| 120624 | RENFERT - O-ring For Tank Lid- (76x3mm ) Basic Duo - #30936  | US\$ 5.07   | +Info |
| 120623 | RENFERT - Handcuff Ring - Slit - #900030923                  | US\$ 10.98  | +Info |
| 120622 | RENFERT - O-ring For Tank Lid Cap- (18x3mm ) Basic - #30226  | US\$ 1.89   | +Info |
| 120621 | RENFERT - Tools For Mt Plus - #21337                         | US\$ 18.28  | +Info |
| 120620 | RENFERT - Hardware For Mt Plus - #21336                      | US\$ 26.61  | +Info |
| 120619 | RENFERT - Four-way Junction Compl. 2954/55 - #21281          | US\$ 245.35 | +Info |
| 120618 | RENFERT - Inside Pressure Regulator Quattros - #21280        | US\$ 185.54 | +Info |
| 120617 | RENFERT - Rear Regulator Basic 2954 Compl. - #21279          | US\$ 174.97 | +Info |
| 120616 | RENFERT - Rear Regulator Compl. Basic 2955 - #21278          | US\$ 174.97 | +Info |
| 120615 | RENFERT - Squeezing Valve Basic 2955 - #21277                | US\$ 184.48 | +Info |
| 120614 | RENFERT - Command Valve Basic 2955 - #21276                  | US\$ 175.93 | +Info |
| 120612 | RENFERT - Protection Cap Safety Switch Mt Plus - #21234      | US\$ 13.84  | +Info |
| 120611 | RENFERT - Oil Atomizer Basic Mobil Compl. - #21155           | US\$ 194.95 | +Info |
| 120610 | RENFERT - Maintenance Unit Basic Prof. Is - #21132           | US\$ 221.38 | +Info |
| 120609 | RENFERT - Manometer With Screw Fitting And Filters - #21131  | US\$ 56.43  | +Info |
| 120608 | RENFERT - Three-way Switch Compl. Basic Prof. Is - #21126    | US\$ 155.43 | +Info |
| 120600 | RENFERT - Squeezing Valve Basic Professional - #20049        | US\$ 263.13 | +Info |

### RENFERT - SUCTION HOSE

RENFERT - SUCTION HOSE -

Suction hose inside diameter 38 mm



| Code   | Name  | Price       | +                     |
|--------|---|-------------|-----------------------|
| 120907 | RENFERT - Suction Hose 9 Meter Length - #902150823                      | US\$ 277.68 | <a href="#">+Info</a> |
| 120906 | RENFERT - Suction Hose 6 Meter Length - #901150823                      | US\$ 189.25 | <a href="#">+Info</a> |
| 120792 | RENFERT - Suction Hose For Silent 3m - incl 2 end mufflers - #900034240 | US\$ 130.91 | <a href="#">+Info</a> |

### Renfert Replacement Parts - RENFERT

Renfert Replacement Parts - RENFERT



| Code          | Name                                | Price       | +                     |
|---------------|-------------------------------------|-------------|-----------------------|
| 417720        | Upgrade light kit- replace old EACH | US\$ 361.23 | <a href="#">+Info</a> |
| 473834        | Transformer Waxelectric             | US\$ 79.81  | <a href="#">+Info</a> |
| 469084        | Drilling unit complete 1840         | US\$ 309.07 | <a href="#">+Info</a> |
| 469067        | Hardware kit for Top Spin 1840      | US\$ 13.84  | <a href="#">+Info</a> |
| 469066        | Printed circuit board 1840          | US\$ 242.50 | <a href="#">+Info</a> |
| 469044        | Motor for Top-spin (110v)           | US\$ 270.07 | <a href="#">+Info</a> |
| 469043        | Printed circuit 115V 1835 4000      | US\$ 199.70 | <a href="#">+Info</a> |
| 469037        | Built-in plug 115 V for Topspi      | US\$ 125.75 | <a href="#">+Info</a> |
| 469036        | Spider for coupling f. Topspin      | US\$ 17.02  | <a href="#">+Info</a> |
| 469033        | Switch- 2 polarities- for Tops      | US\$ 27.66  | <a href="#">+Info</a> |
| 468973        | Drilling unit complete              | US\$ 446.88 | <a href="#">+Info</a> |
| 468966        | Laser module for Top Spin           | US\$ 111.32 | <a href="#">+Info</a> |
| 420844        | Replacement Motor For Silent TS2    | US\$ 318.20 | <a href="#">+Info</a> |
| 417728        | High performance top carbon fi EACH | US\$ 228.23 | <a href="#">+Info</a> |
| 023-2931-0000 | Pneumatic Foot Control-Each         | US\$ 238.34 | <a href="#">+Info</a> |
| 417710        | Set of switches for Vibrax SET      | US\$ 84.06  | <a href="#">+Info</a> |
| 417676        | Rubber table supports Vibrax        | US\$ 61.71  | <a href="#">+Info</a> |
| 417670        | Mains cable 120V black 3 pr Vibrax  | US\$ 13.97  | <a href="#">+Info</a> |
| 417658        | Replac Switch Classic ballas        | US\$ 56.40  | <a href="#">+Info</a> |
| 417653        | Venturi Nozzle                      | US\$ 164.52 | <a href="#">+Info</a> |
| 417652        | Solenoid valve Twister              | US\$ 86.58  | <a href="#">+Info</a> |
| 417651        | Processor Circuit board Twister     | US\$ 222.52 | <a href="#">+Info</a> |
| 417643        | Rubber handle- neutral EACH         | US\$ 21.47  | <a href="#">+Info</a> |
| 417639        | Repair Set Twister bottom           | US\$ 143.28 | <a href="#">+Info</a> |
| 417638        | Dosing nipple swirl nozzle 25/50    | US\$ 10.98  | <a href="#">+Info</a> |

|        |                               |            |                       |
|--------|-------------------------------|------------|-----------------------|
| 417623 | Second Air Valve Twister      | US\$ 74.48 | <a href="#">+Info</a> |
| 417622 | Pneumatic foot pedal ECO EACH | US\$ 72.13 | <a href="#">+Info</a> |

### REPLACEMENT PARTS - RENFERT

### REPLACEMENT PARTS - REFERT



### BASIC MASTER

### BASIC MASTER

| Code   | Name                           | Price       | +                     |
|--------|--------------------------------|-------------|-----------------------|
| 120852 | Replacement Glass- Master/vari | US\$ 120.61 | <a href="#">+Info</a> |

### Other Models

### Other Models

| Code   | Name                             | Price       | +                     |
|--------|----------------------------------|-------------|-----------------------|
| 120938 | Replacement Glass- Keramo Iv     | US\$ 70.30  | <a href="#">+Info</a> |
| 120857 | Replacement Lid Basic 25-500m    | US\$ 53.20  | <a href="#">+Info</a> |
| 120858 | Replacement Lid Basic Is 25 50   | US\$ 94.83  | <a href="#">+Info</a> |
| 120875 | Grate For Basic Classic (2947)   | US\$ 40.43  | <a href="#">+Info</a> |
| 120876 | Grate For Mas/quattro (2958/59)  | US\$ 40.91  | <a href="#">+Info</a> |
| 120891 | Four Way Junction Compl. Quatt   | US\$ 121.63 | <a href="#">+Info</a> |
| 120901 | Replacement Ballast Soft Touch   | US\$ 95.87  | <a href="#">+Info</a> |
| 120918 | Plastic Lid For Tropicana Tray   | US\$ 30.86  | <a href="#">+Info</a> |
| 120920 | Plastic Lid For Tropicolino Tr   | US\$ 38.30  | <a href="#">+Info</a> |
| 120926 | Replacement Glass For Dustex     | US\$ 71.49  | <a href="#">+Info</a> |
| 120932 | Replacement Kit Basic Lamp 230   | US\$ 196.15 | <a href="#">+Info</a> |
| 120853 | Replacement Glass- Quattro/var   | US\$ 90.75  | <a href="#">+Info</a> |
| 417618 | Tools for MT Plus                | US\$ 22.95  | <a href="#">+Info</a> |
| 417645 | Circuit board 110v Millo         | US\$ 210.17 | <a href="#">+Info</a> |
| 417646 | Protective cap Millo             | US\$ 6.38   | <a href="#">+Info</a> |
| 417659 | Rubber Feet for MT3 4pcs         | US\$ 25.54  | <a href="#">+Info</a> |
| 417672 | On/Off switch for MT Plus        | US\$ 152.55 | <a href="#">+Info</a> |
| 417678 | Set of fuses MT3 pro SET         | US\$ 21.95  | <a href="#">+Info</a> |
| 417679 | Door for MT3                     | US\$ 150.49 | <a href="#">+Info</a> |
| 417700 | On/Off-switch 120V MT3           | US\$ 127.81 | <a href="#">+Info</a> |
| 417701 | Door MT3 PRO                     | US\$ 194.95 | <a href="#">+Info</a> |
| 417709 | Holder for trimmer table MT3/pro | US\$ 20.22  | <a href="#">+Info</a> |
| 120711 | Stand Mount With Screw Clamp     | US\$ 173.17 | <a href="#">+Info</a> |
| 120601 | Halogen Lamp Head Complete       | US\$ 118.73 | <a href="#">+Info</a> |
| 120602 | Foot Switch For Poretta          | US\$ 149.82 | <a href="#">+Info</a> |
| 120603 | Conversion Kit Gas inhin 932-933 | US\$ 63.84  | <a href="#">+Info</a> |
| 120604 | Conversion Kit Propane infin932- | US\$ 58.62  | <a href="#">+Info</a> |
| 120606 | Manometer With Screw Fitting     | US\$ 47.89  | <a href="#">+Info</a> |

|        |                                |             |       |
|--------|--------------------------------|-------------|-------|
| 120648 | Replacement Base For Pin Cast- | US\$ 120.61 | +Info |
| 120651 | Geo Aesthetics Add Wax         | US\$ 28.74  | +Info |
| 120669 | Aderer Clasp Bending Pliers    | US\$ 59.84  | +Info |
| 120692 | Cross-cut- Cylindrical Bur     | US\$ 153.59 | +Info |
| 120710 | Stand With Universal Clamp     | US\$ 45.42  | +Info |
| 120599 | Press. Cont. Basic Prof. Is Co | US\$ 223.80 | +Info |
| 120725 | Silencer (hose Baffel)         | US\$ 91.74  | +Info |
| 120726 | Magnifier For sandblasters     | US\$ 271.03 | +Info |
| 120736 | Set Of Filters New Pillos      | US\$ 8.78   | +Info |
| 120755 | Replacement Glass Coated Maste | US\$ 107.07 | +Info |
| 120756 | Replacement Glass Coated Class | US\$ 109.26 | +Info |
| 120766 | Replacement Glass- Prof/classi | US\$ 90.71  | +Info |
| 120794 | Hose Adapter For Suction Units | US\$ 36.92  | +Info |
| 120814 | Replacement Ballast Prof/maste | US\$ 312.87 | +Info |
| 120815 | Replacement Switch Quat/mas/pr | US\$ 71.30  | +Info |

### Silent

Silent

| Code   | Name                            | Price       | +     |
|--------|---------------------------------|-------------|-------|
| 120717 | End Mufflers For Silent Hose    | US\$ 23.41  | +Info |
| 120718 | External AIR-FLOW Duct For Sile | US\$ 176.45 | +Info |
| 120942 | Replacement Motor For Silent T  | US\$ 318.20 | +Info |

## REPLACEMENTS PARTS FOR TWISTER MIXING - RENFERT

### REPLACEMENTS PARTS FOR TWISTER MIXING - RENFERT

These spare parts will make their dental units more efficient by replacing the broken parts or that do not work for new parties to extend the life of use of your machine



### MIXING BOWL - RENFERT

#### MIXING BOWL - RENFERT

#### Function & Performance

Well-designed paddle geometry for optimal, thorough mixing.

#### Advantages

- \* Marking indicates maximum filling capacity.
- \* Reservoir protects against unintentional over filling.
- \* Bowl made from high-strength polycarbonate.

**US DENTAL DEPOT Is An Official Renfert Dealer**





### MIXING BOWL WITH PADDLE- COMPLETE

| Code      | Name  | Price       | +     |
|-----------|---|-------------|-------|
| 1820-6500 | RENFERT - Mixing Bowl Complete 65ml- #1820-6500 #18206500 1820-6500   | US\$ 210.77 | +Info |
| 111895    | RENFERT - Mixing Bowl Complete 200ml- #1820-0200 #18200200 1820-200   | US\$ 211.91 | +Info |
| 1820-0500 | RENFERT - Mixing Bowl Complete 500ml- #1820-0500 #18200500 1820-0500  | US\$ 221.29 | +Info |
| 1820-0700 | RENFERT - Mixing Bowl Complete 700ml- #1820-0700 #18200700 1820-0700  | US\$ 236.21 | +Info |
| 1820-1001 | RENFERT - Mixing Bowl Complete 1000ml- #1820-1001 #18201001 1820-1001 | US\$ 273.47 | +Info |

### MIXING BOWL - ONLY

| Code      | Name   | Price      | +     |
|-----------|--|------------|-------|
| 1820-0520 | RENFERT - Mixing bowl Only 500ml- #1820-0520 #18200520 1820-0520 | US\$ 72.35 | +Info |
| 1820-0220 | RENFERT - Mixing Bowl Only 200ml- #1820-0220 #18200220 1820-0220 | US\$ 54.27 | +Info |

### PADDLE AND LID

| Code      | Name  | Price       | +     |
|-----------|---|-------------|-------|
| 120694    | RENFERT - Paddle And Lid For Bowl- 65ml - #18206510                     | US\$ 51.54  | +Info |
| 1820-1010 | RENFERT - Paddle and Lid For Bowl 100ml- #1820-1010 #18201010 1820-1010 | US\$ 280.78 | +Info |
| 1820-0710 | RENFERT - Paddle and Lid for Bowl 700ml- #1820-0710 #18200710 1820-0710 | US\$ 51.54  | +Info |
| 1820-0210 | RENFERT - Paddle And Lid for Bowl 200ml- #1820-0210 #18200210 1820-0210 | US\$ 51.54  | +Info |
| 1820-0510 | RENFERT - Paddle and lid for bowl 500ml- #1820-0510 #18200510 1820-0510 | US\$ 190.13 | +Info |

### ALGINATE MIXING PADDLE

| Code   | Name  | Price       | +     |
|--------|---|-------------|-------|
| 120696 | RENFERT - Alginate Mixing Bowl Complete 500ml - #18230500 | US\$ 293.94 | +Info |
| 120697 | RENFERT - Alginate Mixing Paddle 500ml - #18230510        | US\$ 103.08 | +Info |
| 120698 | RENFERT - Alginate Mixing Bowl 500ml - #18230520          | US\$ 73.82  | +Info |

### Other Models

Other Models

| Code   | Name                           | Price      | +     |
|--------|--------------------------------|------------|-------|
| 120785 | O Ring Set For All Twister Bow | US\$ 42.56 | +Info |
| 120922 | Twister Rotary Knob Set        | US\$ 33.92 | +Info |

## ULTRASONIC ACCESSORIES | RENFERT





### ACCESSORIES FOR EASY CLEAN ULTRASONIC UNITS - RENFERT

#### ACCESSORIES FOR EASY CLEAN ULTRASONIC UNITS - RENFERT

These accessories will make your portable dental units more efficient and improve the quality and function of your machine.



| Code         | Name   | Price       | +     |
|--------------|--|-------------|-------|
| 120759       | RENFERT - Front Foil For Easyclean - #900030775                                    | US\$ 90.71  | +Info |
| 23-1850-0005 | RENFERT - Plastic Acid Bath Insert for EasyClean- #1850-0005 #18500005             | US\$ 86.52  | +Info |
| 23-1850-0003 | RENFERT - Stainless Steel Basket for EasyClean- #1850-0003 #18500003               | US\$ 78.58  | +Info |
| 23-1850-0002 | RENFERT - Stainless Steel Cover for EasyClean #1850-0002 #18500002                 | US\$ 77.31  | +Info |
| 23-1850-0004 | RENFERT - Stainless Steel Immersion Basket for EasyClean- #1850-0004 #18500004     | US\$ 102.05 | +Info |
| 23-1850-0001 | RENFERT - Plastic Lid for EasyClean-#1850-0001 #1850-0001 #18500001                | US\$ 42.56  | +Info |
| 23-1850-0006 | RENFERT - Cleaning Jar with Lid and rubber band 600ml for EasyClean-#1850-0006 ... | US\$ 81.44  | +Info |
| 120758       | RENFERT - Knob For Easyclean - #900030774  | US\$ 27.93  | +Info |
| 120757       | RENFERT - Fuses For Easyclean - #900030118   | US\$ 17.02  | +Info |
| 23-1850-0007 | RENFERT - Plastic container with Lid for EasyClean- #1850-0007 #18500007           | US\$ 13.84  | +Info |
| 120701       | RENFERT - Plastic Container For Easyclean - #18500007                              | US\$ 13.84  | +Info |
| 417635       | RENFERT - Temperature sensor complete Easyclean PIEC - #900030782                  | US\$ 85.56  | +Info |
| 417636       | RENFERT - Ultrasonic well complete 110V EACH - #900030787                          | US\$ 261.58 | +Info |
| 417634       | RENFERT - PTC heating element Easyclean 110v- #900030781                           | US\$ 78.74  | +Info |

### ACCESSORIES FOR SYMPRO - RENFERT



### Cleaning Agents SYMPRO

| Code   | Name                           | Price       | +     |
|--------|--------------------------------|-------------|-------|
| 470724 | SYMPRO help:ex plaque f. 4x1lt | US\$ 113.38 | +Info |
| 470725 | SYMPRO Help:ex plaque 20pk 20G | US\$ 87.62  | +Info |
| 470726 | SYMPRO Help:ex discolor f 1lt  | US\$ 30.32  | +Info |
| 477161 | SYMPRO Denture cleaning unit   | US\$ 110.02 | +Info |

### Sympro

Sympro

| Code        | Name                        | Price       | +     |
|-------------|-----------------------------|-------------|-------|
| 23-65000450 | SYMPRO disinfectable beaker | US\$ 40.71  | +Info |
| 23-65000460 | SYMPRO disinfectable beaker | US\$ 104.11 | +Info |
| 23-65000550 | Sympro Cleaning Needle 75gr | US\$ 73.42  | +Info |
| 417614      | SYMPRO Mini-Becher 1pk      | US\$ 19.15  | +Info |
| 417615      | SYMPRO mini-cup Set         | US\$ 73.42  | +Info |

### Ultrasonic Accessories - RENFERT

Ultrasonic Accessories - RENFERT

| Code   | Name                      | Price      | +     |
|--------|---------------------------|------------|-------|
| 120780 | Plastic Tweezers (sympro) | US\$ 25.54 | +Info |
| 120781 | Retainer Magnet (sympro)  | US\$ 44.69 | +Info |

## General Parts & Replacenents

### Replacement Parts COLTENE



### PINDEX SYSTEM - COLTENE

| Code   | Name                                | Price       | +     |
|--------|-------------------------------------|-------------|-------|
| 433618 | Pindex Reamer, Package of 1         | US\$ 59.59  | +Info |
| 431698 | Pindex Laser Retro Fit Kit (for Mar | US\$ 399.09 | +Info |

### Replacement Parts COLTENE - COLTENE

Replacement Parts COLTENE - COLTENE

| Code   | Name                                | Price         | +     |
|--------|-------------------------------------|---------------|-------|
| 426603 | BioSonic UC300R BioSonic UC 300R Re | US\$ 4,117.03 | +Info |

### Ultrasonic Accessories - COLTENE

Ultrasonic Accessories - COLTENE



| Code   | Name                                | Price       | +     |
|--------|-------------------------------------|-------------|-------|
| 420816 | Biosonic Ultrasonic Basket          | US\$ 196.04 | +Info |
| 426537 | BioSonic Borosilicate Ultrasonic Cl | US\$ 24.49  | +Info |

|        |                                     |             |                       |
|--------|-------------------------------------|-------------|-----------------------|
| 426776 | BioSonic Large FingerGuard Basket w | US\$ 225.00 | <a href="#">+Info</a> |
| 430795 | BioSonic UC125 Cleaner Accessory Ki | US\$ 225.65 | <a href="#">+Info</a> |
| 436460 | BioSonic UC152 Three-Quarter Size   | US\$ 137.61 | <a href="#">+Info</a> |
| 426534 | BioSonic UC100XD Full Size FingerGu | US\$ 147.03 | <a href="#">+Info</a> |
| 426839 | BioSonic UC 300 Two-Beaker Holder,  | US\$ 91.57  | <a href="#">+Info</a> |
| 430726 | BioSonic UC 100 Single Beacker Hold | US\$ 37.64  | <a href="#">+Info</a> |
| 436459 | BioSonic Small Parts Basket UC125 a | US\$ 14.90  | <a href="#">+Info</a> |

### General Parts & Replacenents

## SHOFU Replacement Parts

### Parts for LC Curing units

| Code   | Name   | Price      | +                     |
|--------|--|------------|-----------------------|
| 467823 | SHOFU Solidite Replacement Bulbs #16SB #5610 | US\$ 20.84 | <a href="#">+Info</a> |

### REPLACEMENT PARTS for SHOFU



| Code   | Name                                       | Price       | +                     |
|--------|--|-------------|-----------------------|
| 112065 | SHOFU Lab Air Z Chuck Tool - #5223         | US\$ 19.31  | <a href="#">+Info</a> |
| 112066 | SHOFU Lab Air Z Cart Tool - #5224          | US\$ 34.27  | <a href="#">+Info</a> |
| 112064 | SHOFU Lab Air Z Chuck - #5222              | US\$ 57.45  | <a href="#">+Info</a> |
| 112069 | SHOFU Lab Air Z Filter/ Regulator - #5234  | US\$ 140.40 | <a href="#">+Info</a> |
| 112068 | SHOFU Lab air Foot Air Controller - #E0023 | US\$ 192.73 | <a href="#">+Info</a> |

### General Parts & Replacenents

## TPC Replacement Parts

### TPC Replacement Parts - TPC

#### TPC Replacement Parts - TPC

| Code   | Name                                | Price       | +                     |
|--------|-------------------------------------|-------------|-----------------------|
| 470398 | BELMONT CHAIR BRACKET Accessories   | US\$ 166.32 | <a href="#">+Info</a> |
| 473620 | Female Quick Disconnect (Factory In | US\$ 117.60 | <a href="#">+Info</a> |
| 470429 | L700 Replacement REFLECTOR          | US\$ 134.40 | <a href="#">+Info</a> |
| 470426 | Nylon Bushing Fits 2" Post (1-7/8"  | US\$ 17.42  | <a href="#">+Info</a> |
| 470425 | Nylon bushing fits 2" posts (1-7/8" | US\$ 17.60  | <a href="#">+Info</a> |
| 470423 | Light Post Straight, 48" (LP48-PC)  | US\$ 151.20 | <a href="#">+Info</a> |

|        |                                     |             |       |
|--------|-------------------------------------|-------------|-------|
| 470402 | Deluxe Autoclavable Saliva Ejector  | US\$ 45.36  | +Info |
| 470401 | Deluxe (Short) Autoclavable HVE Val | US\$ 56.28  | +Info |
| 470400 | Deluxe (Long) Autoclavable HVE Valv | US\$ 56.28  | +Info |
| 473624 | UNIT HANDPIECE CONTROL TRI-BLOCK -  | US\$ 84.00  | +Info |
| 470389 | MIRAGE Chair & Electric Motor Touch | US\$ 386.40 | +Info |
| 470387 | MIRAGE TOUCH PAD CONTROL Accessorie | US\$ 300.72 | +Info |
| 470384 | Mirage Wall/Cabinet Mount Ass't Ins | US\$ 252.00 | +Info |
| 470366 | Optional Stone Surface on OMC-2375, | US\$ 304.00 | +Info |
| 470365 | Optional Stone Surgace on OMC-2375, | US\$ 304.00 | +Info |
| 470363 | Optional Stone Surface on OMC-2375, | US\$ 304.00 | +Info |
| 470362 | Monitor BRACKET for Ortho.Cabinet ( | US\$ 252.00 | +Info |
| 469757 | Glass Beakers (500ml) X 2 and Holde | US\$ 56.00  | +Info |
| 473626 | FLOW CONTROL NEEDLE VALVE - Parts & | US\$ 13.20  | +Info |
| 473627 | PUSH BUTTON MOMENTARY - Parts & Com | US\$ 11.20  | +Info |
| 473628 | VALVE ON-OFF 2-WAY - Parts & Compon | US\$ 11.20  | +Info |
| 473629 | ON/OFF 3-WAY VALVE - Parts & Compon | US\$ 12.00  | +Info |
| 473630 | NON-RETRACTION WATER RELAY - Parts  | US\$ 29.40  | +Info |
| 473631 | CHECK VALVE - Parts & Components    | US\$ 11.25  | +Info |
| 473635 | Sheathed Syringe Tubing 6' - Parts  | US\$ 14.40  | +Info |
| 473637 | 4 HOLE ADAPTER METAL ONLY - Parts & | US\$ 9.56   | +Info |
| 473638 | 4 HOLE BRASS NUT ONLY - Parts & Com | US\$ 5.00   | +Info |
| 473641 | MALE QCK DISC. w/SHUT-OFF, 1/4" - P | US\$ 11.70  | +Info |
| 473642 | MALE QCK DISC. w/SHUT-OFF, 3/8" - P | US\$ 17.60  | +Info |
| 473643 | FOOT CONTROL W/O SWITCH - Parts & C | US\$ 65.52  | +Info |
| 473644 | Unit Foot Control w/Switch (Wet/Dry | US\$ 97.44  | +Info |
| 473645 | TOGGLE SWITCH for Unit Foot Contro  | US\$ 4.00   | +Info |
| 473646 | Unit Foot Control Water Toggle Assy | US\$ 20.16  | +Info |
| 469721 | MONITOR BRACKET WALL PLATE ADAPTER  | US\$ 78.75  | +Info |
| 464096 | Advanced Technology Prophy Brush    | US\$ 30.40  | +Info |
| 464104 | Advance 800 Piezo Ultrasonic Built  | US\$ 0.00   | +Info |
| 464112 | TPC Advanced Technology Fine tip -  | US\$ 0.00   | +Info |
| 469687 | LIGHT GUIDE/PLASMAI ARC LIGHT       | US\$ 107.44 | +Info |
| 469697 | H6000 LUBRICATION FLUID 1 Lit.      | US\$ 44.80  | +Info |
| 469698 | Mist Filter Sponges 12pk            | US\$ 16.80  | +Info |
| 469699 | FILTER STRIP 20/PK                  | US\$ 13.36  | +Info |
| 469710 | Camera Mounted LCD Display 2.5"     | US\$ 112.00 | +Info |
| 469711 | AdvanceCAM Wireless Transmitter     | US\$ 156.80 | +Info |
| 469712 | CAMERA HOLDER                       | US\$ 24.00  | +Info |
| 469715 | WIRELESS RECEIVER FOR FILM READER   | US\$ 94.50  | +Info |
| 469716 | POST MOUNT FLAT SCREEN MONITOR BRAC | US\$ 99.12  | +Info |
| 469717 | POST MOUNT FLAT SCREEN MONITOR BRAC | US\$ 327.60 | +Info |
| 469718 | POST MOUNT FLAT SCREEN MONITOR BRAC | US\$ 174.80 | +Info |
| 469719 | 100MM FLAT SCREEN ADAPTOR PLAT      | US\$ 17.60  | +Info |
| 464089 | TPC Advanced Technology Prophy Brus | US\$ 30.40  | +Info |
| 469736 | SCALER TIP WRENCH ONLY              | US\$ 18.40  | +Info |
| 469739 | METAL BASKET FOR UC400 & UC450      | US\$ 67.20  | +Info |
| 469740 | UC400 Accessory Kit (Includes: Posi | US\$ 51.20  | +Info |
| 469741 | GLASS BEAKER 500ml - Each           | US\$ 15.20  | +Info |
| 469742 | METAL BASKET FOR UC1000 & UC1050    | US\$ 102.40 | +Info |

|        |                                     |            |                       |
|--------|-------------------------------------|------------|-----------------------|
| 469743 | UC1000 Accessory Kit (Includes: Pos | US\$ 52.80 | <a href="#">+Info</a> |
| 469748 | Plastic Basket for UC250            | US\$ 14.08 | <a href="#">+Info</a> |
| 469749 | Plastic Basket for UC300            | US\$ 14.08 | <a href="#">+Info</a> |
| 469750 | Plastic Basket for UC600            | US\$ 17.60 | <a href="#">+Info</a> |
| 469751 | Plastic Basket for UC750            | US\$ 21.12 | <a href="#">+Info</a> |
| 469752 | SS Rack & Tray (25mm height) For U  | US\$ 56.00 | <a href="#">+Info</a> |
| 469753 | SS Rack & Tray (50mm height) For U  | US\$ 68.80 | <a href="#">+Info</a> |
| 469754 | SS Rack & Tray (27mm Height) For U  | US\$ 73.60 | <a href="#">+Info</a> |
| 469755 | SS Rack & Tray (70mm height) For U  | US\$ 92.75 | <a href="#">+Info</a> |
| 469756 | SS Rack & Tray (70 mm Height) For   | US\$ 86.92 | <a href="#">+Info</a> |

### General Parts & Replacenents

## voltage transformer



### Voltage transformer - ECCO

voltage transformer - ECCO

| Code   | Name                          | Price       | +                     |
|--------|-------------------------------|-------------|-----------------------|
| 103380 | ECCO Voltage Transf. 220-110v | US\$ 19.53  | <a href="#">+Info</a> |
| 114087 | ECCO Voltage Transf. 110-220v | US\$ 20.78  | <a href="#">+Info</a> |
| 123439 | ECCO Plug Adaptor 220-110v    | US\$ 6.19   | <a href="#">+Info</a> |
| 416779 | Voltage Transf. 220-110v      | US\$ 254.40 | <a href="#">+Info</a> |

### Voltage transformer - HOUSE BRAND

voltage transformer - HOUSE BRAND

| Code   | Name                           | Price       | +                     |
|--------|--------------------------------|-------------|-----------------------|
| 469767 | Voltage Transformer 110 to 220 | US\$ 110.88 | <a href="#">+Info</a> |

### General Parts & Replacenents

## WOODPECKER Replacement Parts



### WOODPECKER Replacement Parts - WOODPECKER

WOODPECKER Replacement Parts - WOODPECKER

| Code   | Name                                | Price      | +                     |
|--------|-------------------------------------|------------|-----------------------|
| 458641 | Woodpecker Replacement Head for iLE | US\$ 45.00 | <a href="#">+Info</a> |

## Catalog Index / Indice

|   |    |
|---|----|
| Air Handpieces Replacement Parts .....  | 1  |
| ART Replacement parts ( Bonart ) .....  | 1  |
| ASEPTICO Replacement Parts .....        | 1  |
| BestQual Replacement parts .....        | 3  |
| BUFFALO Replacement parts .....         | 3  |
| Dentsply Replacement Parts .....        | 5  |
| General Replacement Parts .....         | 26 |
| HANDLER General Replacement parts ..... | 28 |
| Model Trimmer Replacement Parts .....   | 28 |
| Reliable Replacement Parts .....        | 30 |
| Renfert Replacement Parts .....         | 30 |
| Replacement Parts COLTENE .....         | 40 |
| SHOFU Replacement Parts .....           | 41 |
| TPC Replacement Parts .....             | 41 |
| voltage transformer .....               | 43 |
| WOODPECKER Replacement Parts .....      | 43 |